



WIPLINE FLOATS • SKIS • MODIFICATIONS • AIRCRAFT SALES
AVIONICS • INTERIOR • MAINTENANCE • PAINT REFINISHING

SERVICE LETTER 143 2100A, 2350A MAIN LANDING GEAR PROXIMITY SWITCH

By: RCG	Aircraft Makes/Model(s): N/A	Float Model(s): 2100A 2350A	Note(s): Mandatory Compliance Service Letter P/N 1005934
Approved: JRS			
Date: 2/20/2018			
Revision: C			

LOG OF REVISIONS

Revision	Description	Date
A	Initial Release	5/6/2014
B	Repositioned upper and lower switches to eliminate intermittent illumination	7/30/2014
C	Revised for greater clarity, added reference to service letters 97 and 139	2/20/2018

FAA approval has been obtained for technical data in this publication that affects STC or TSO design compliance

EFFECTIVITY:

This service letter applies to aircraft listed above with:

- Wipline 2100 amphibious floats SN 21862 and prior
- Wipline 2350 amphibious floats SN 23150 and prior

NOTE: This service letter assumes Wipaire service letter 97 and 139 have already been complied with

COMPLIANCE:

Mandatory compliance for all floats with the 1002574 cylinder installed and recommended for earlier models without the 1002574 cylinder installed

If revision B or prior of this service letter has been complied with, no additional modifications are needed

BACKGROUND:

A possible cylinder or coupler failure may still indicate gear actuation

COMPLIANCE METHOD:

Install new parts included in this service letter in accordance with the Work Instruction section of this service letter

APPROXIMATE SHOP HOURS:

This service letter will take approximately 3.5 labor hours to complete

WARRANTY INFORMATION:

Parts are included for this modification. Contact Wipaire customer service to order the kit

TECHNICAL DATA:

Copies of this service letter, associated service kit, float service manual, and float parts manual are available at www.wipaire.com

See photos and figures below for details to aid in performing this modification

See Table 1 below for a list of parts included in the service kit



ITEMS PROVIDED IN SERVICE KIT (ONE KIT PER FLOAT SET)

ITEM	QTY	PART NUMBER	DESCRIPTION
-	1	1005934-01	KIT, SERVICE LETTER 143, 2100 MAIN GEAR PROXIMITY SWITCH
1	2	1003343	DOUBLER, PROXIMITY SWITCH
2	2	1005875	ASSEMBLY, PIN, CLEVIS, MAGNET HOLDER
3	1	1005933	TEMPLATE, PROXIMITY SWITCH LOCATION, 2100 MAIN GEAR
4	8	MS21044N04	NUT
5	2	MS24665-283	COTTER PIN
6	8	MS24693-S6	MACHINE SCREW
7	8	NAS1149FN432P	WASHER
8	1	PR-1422-B-2-654	6 OZ. MODEL 654 SEMKIT

TABLE 1

WORK INSTRUCTION

1. Per Wipaire maintenance manual, jack aircraft enough to relieve load on the front and main gear
2. Remove the outboard main gear side access cover
3. Locate and label the upper and lower proximity switches

Showing instruction for right float installation. Mirror instruction when installing left float components

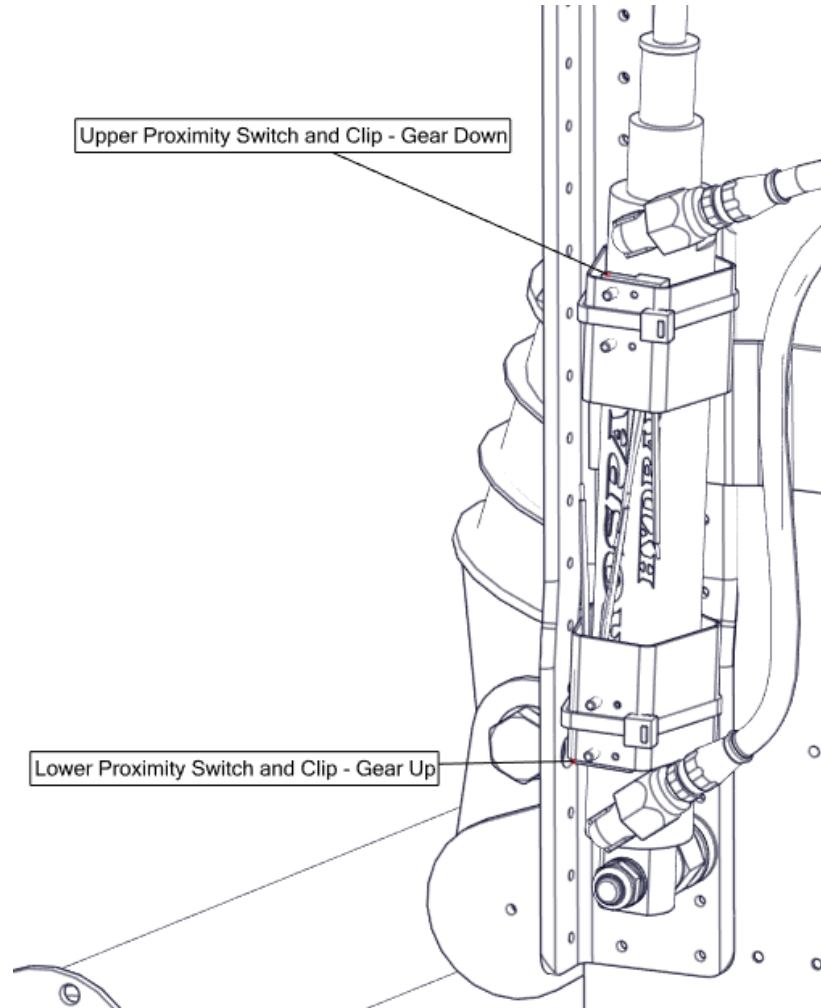

4. Remove the upper and lower proximity switches and discard the clips, zip ties, and screws

NOTE: Do not remove the proximity switch from the wiring harness

5. Remove the MS21083N5 nut and NAS1149F0563P washers from the lower hydraulic actuator and set aside for later use

NOTE: Do not remove hydraulic actuator

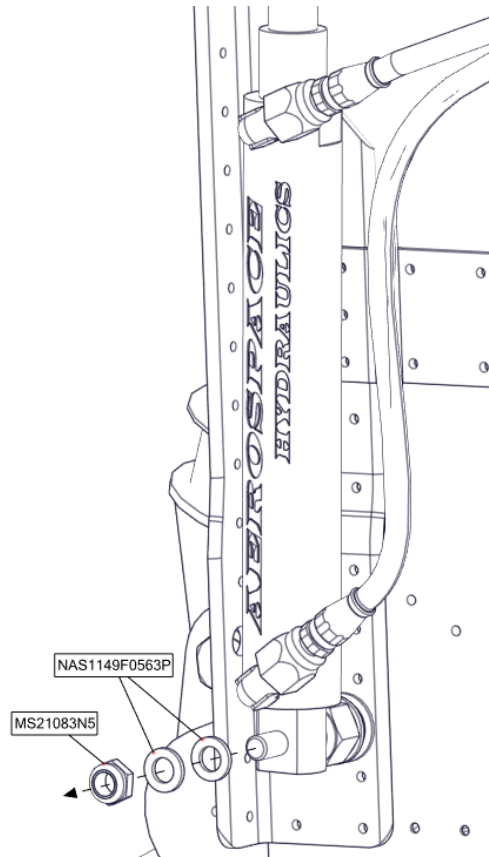

6. Place 1003343 proximity switch doubler where shown and match drill (2) #30 holes into the wheel well side panel

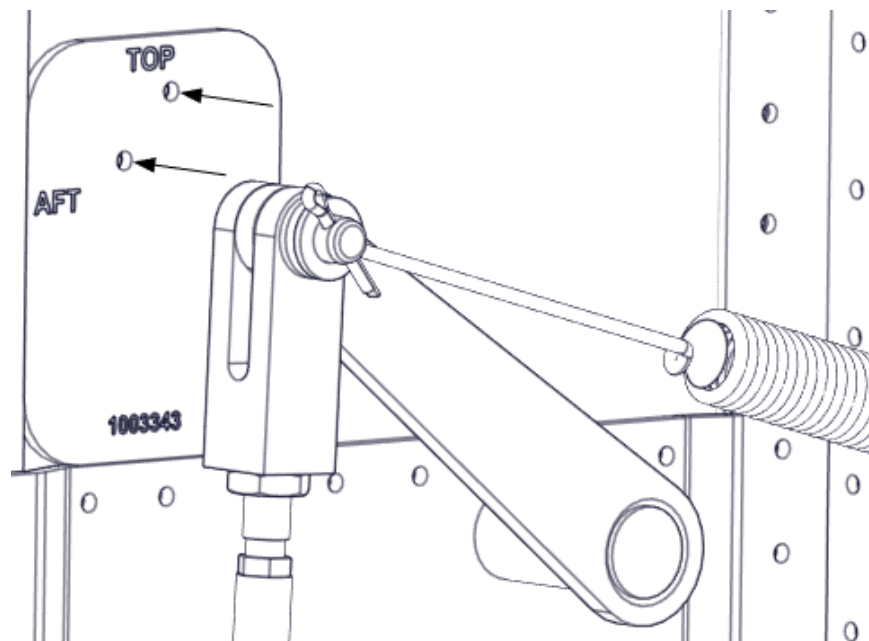

7. Deburr drilled holes and seal 1003343 proximity switch doubler to wheel well side panel using PR-1422-B-2 sealant or equivalent
8. Place 1005933 proximity switch location drill template where shown and match drill (2) #30 holes into the wheel well side panel

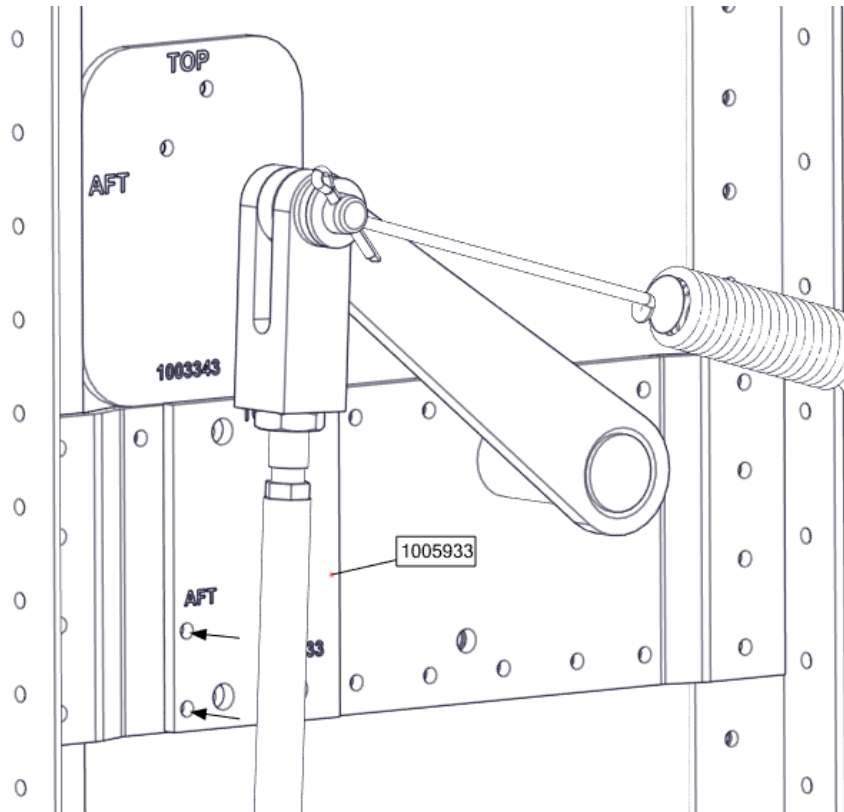

9. Remove 1005933 proximity switch location drill template and drill out the rivet shown. Countersink the rivet hole and reinstall rivet so it is flush on both sides

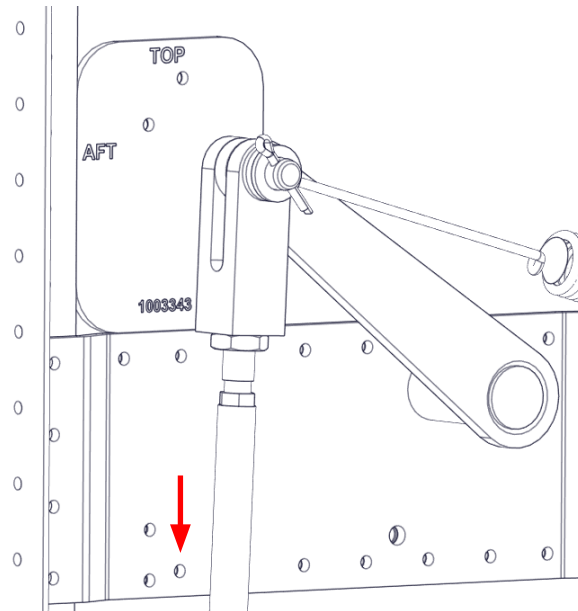

10. Countersink the backside of (4) drilled holes so MS24693-S6 screws will be flush when installed
11. Install MS24693-S6 screws wet as shown with PR-1422-B-2 sealant or equivalent

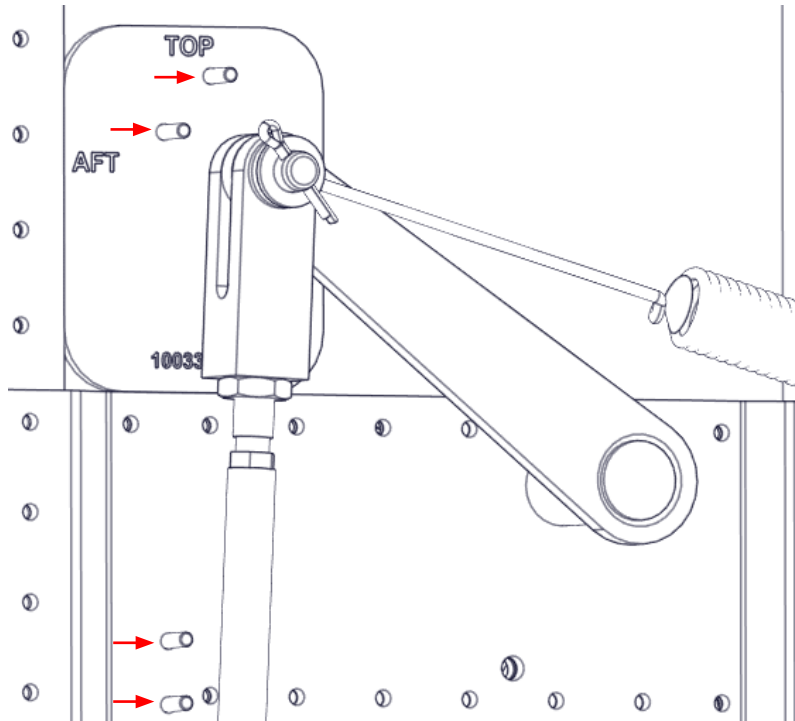

12. Position upper and lower proximity switches where shown and loosely attach using (4) NAS1149FN432P washers and (4) MS21044N04 nuts

NOTE: Verify the upper switch and lower switch were connected to the correct upper and lower wiring harnesses

NOTE: Verify the wiring harnesses do not interfere with the actuation of the main gear. Zip tie wiring harnesses as needed

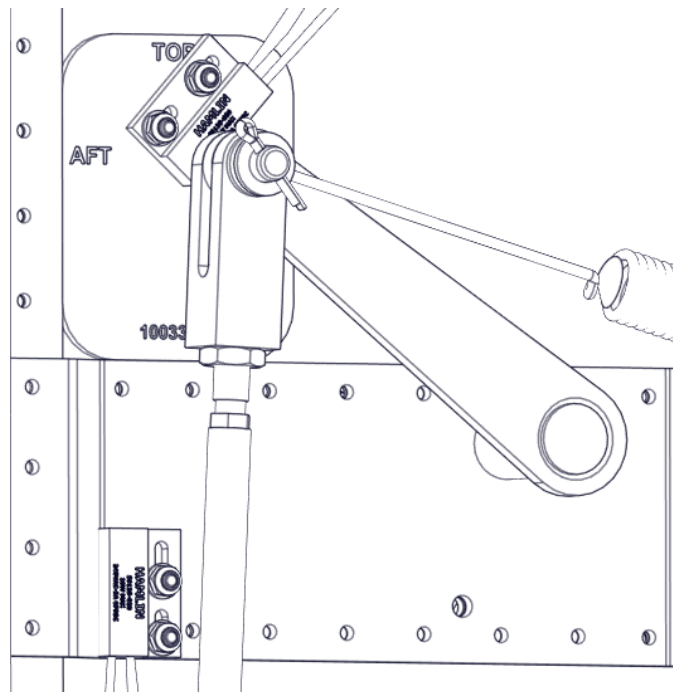

13. Remove top access cover shown



14. Remove (2) NAS6204-17 bolts, (4) NAS1149F0463P washers, and (2) MS21083N4 nuts and set aside for later use

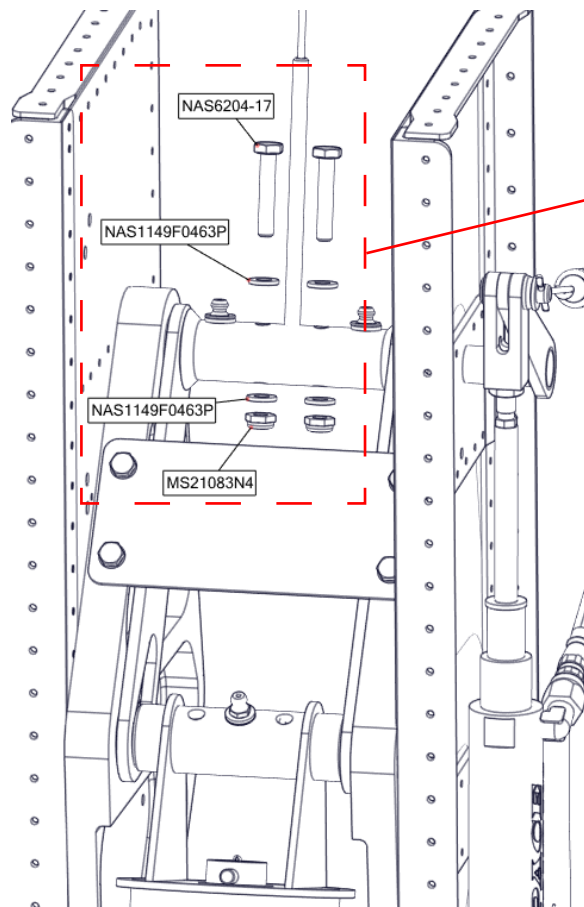

Hardware shown on Main Gear Retraction Assembly may vary depending on the date the float was manufactured. Use hardware shown as reference only and use existing installed hardware during reassembly.

15. Remove MS24665-283 cotter pin, MS20392-4C29 clevis pin, NAS1149F0532P and (2) NAS1149F0563P washers. Discard MS20392-4C29 clevis pin and MS24665-283 cotter pin. Retain (3) washers for later use

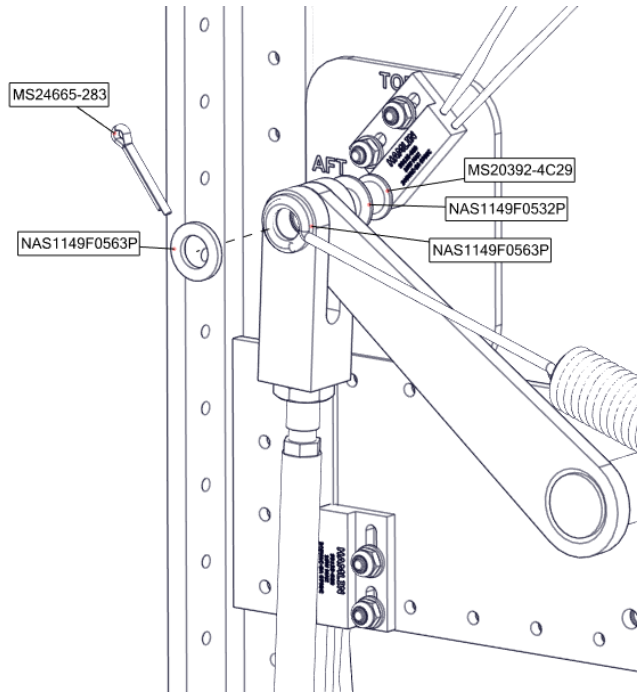
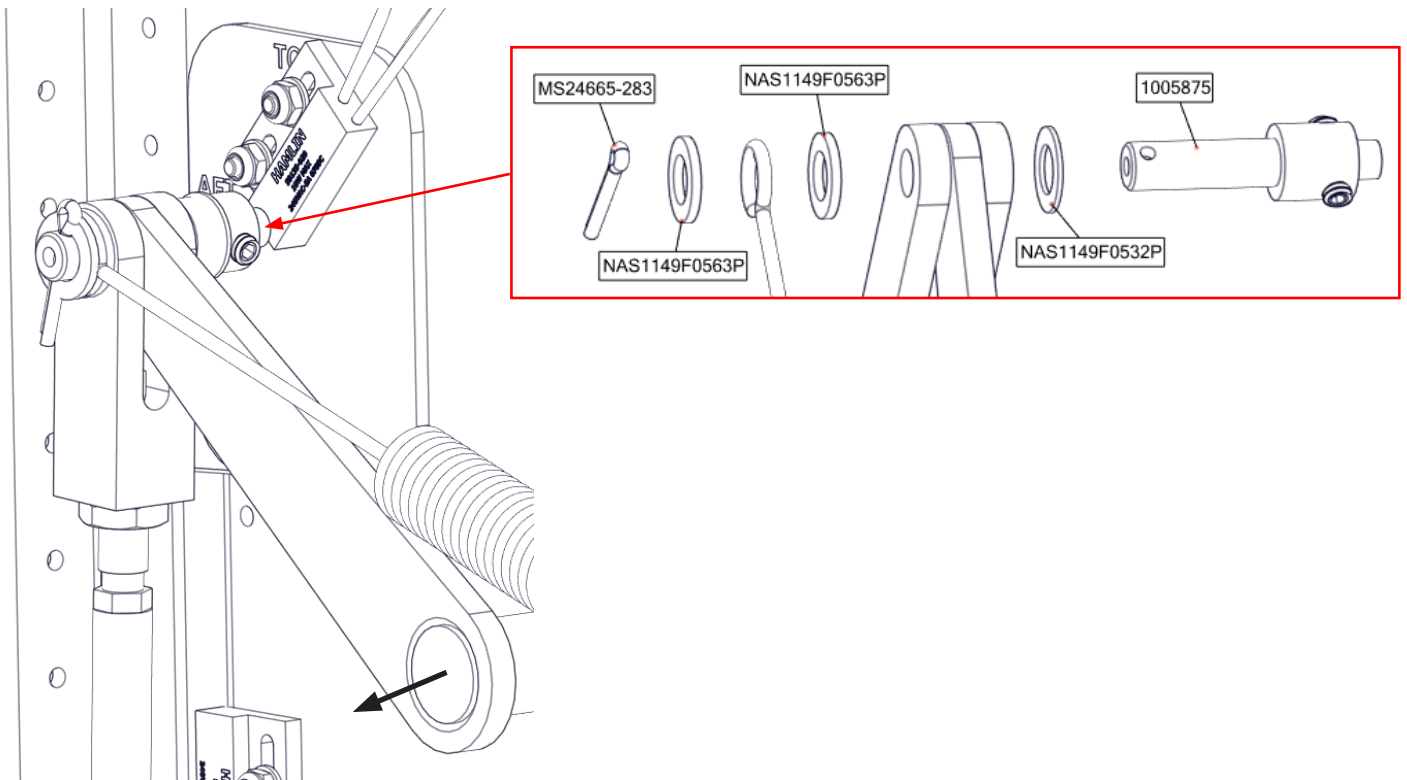

Image depicts previous service letter compliance. See front page Effectivity Note

16. Insert 1005875 magnet holder clevis pin assembly, (2) NAS1149F0532P and (1) NAS1149F0563P washers where shown

NOTE: Pull actuator arm in direction shown to allow more space for 1005875 magnet hold clevis pin assembly installation



17. Reinsert the actuator arm, using NAS1149F1032P and/or NAS1149F1063P washers as needed where shown to reduce excess free play

NOTE: The main gear must still be able to rotate without interference caused from the washers installed above

NOTE: To determine if gear has excess free play, pull arm all the way to one side, and on the opposing side measure distance between the main gear track and the arm. Distance should be .020" - .030".

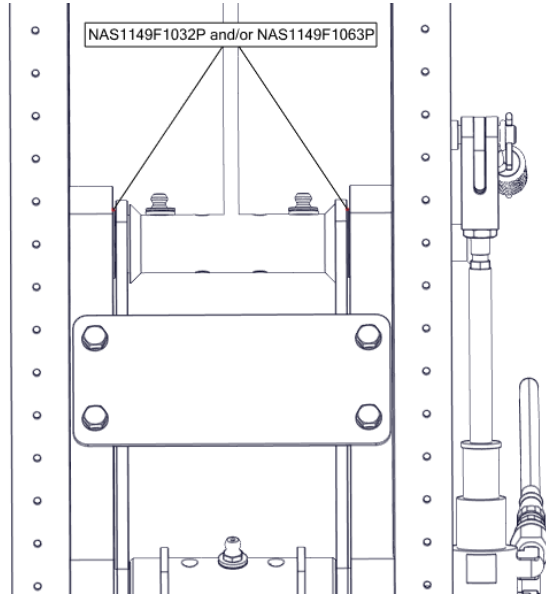

18. Reinstall (2) NAS6204-17 bolts, (4) NAS1149F0463P washers, and (2) MS21083N4 nuts where shown

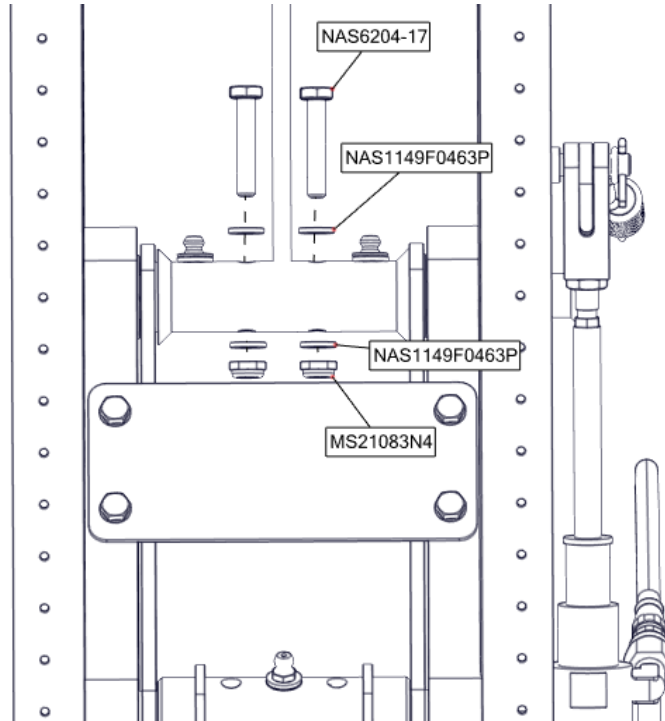

19. Adjust the distance between the magnet and upper and lower proximity switches and secure using set screws and thread lock or epoxy

NOTE: Allow approximately 1/32" of clearance between magnet and switches when actuator arm is pushed toward the switches

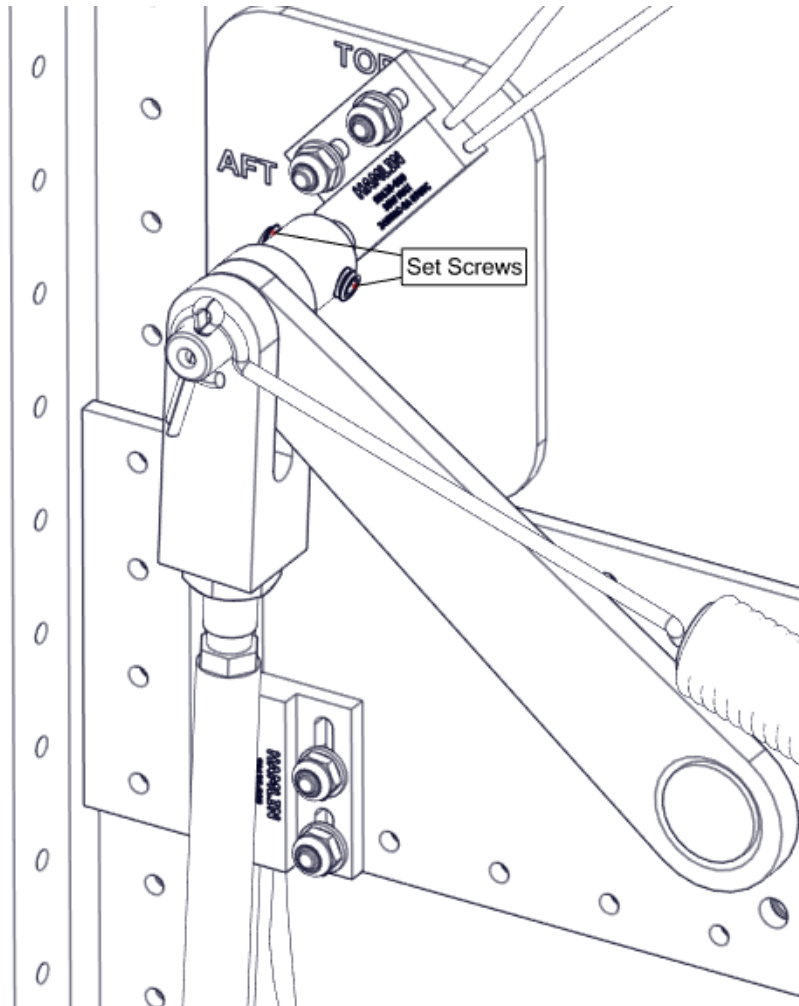

20. Confirm upper and lower proximity switches are in the correct position by running the gear, then tighten (4) MS21044N04 nuts
21. Fully cycle the hydraulic gear system up and down to ensure correct operation

NOTE: Refer to Wipaire Float Model 2100/2350 Service Manual for further rigging and gear indication instructions

22. Reinstall top and outboard main gear side access covers
23. Remove aircraft jacks

NOTES:

1. Upon completion of inspection, enter information in Aircraft Logbook for completion of Wipaire Service Letter 143
2. Once service letter is accomplished, please visit www.wipaire.com and update your aircraft service letter/kit record using the link found on the Customer Support dropdown menu under "Update Service Letter & Kit Compliance Status"