



<b>SERVICE LETTER NUMBER 139</b>			
<b>TITLE: MAIN LANDING GEAR (MLG) THREADED COUPLER</b>			
BY: S. ST. JACQUE	AIRCRAFT MAKE/MODEL(S):  N/A	FLOAT MODEL(S):  2100, 2350	NOTE(S): MANDATORY COMPLIANCE <b>S/L P/N 1005856</b> <b>ECO 23053</b>
APP: D.GARRETT			
DATE: 03/15/13			
REV: A			

**FAA APPROVAL HAS BEEN OBTAINED FOR TECHNICAL DATA IN THIS PUBLICATION THAT AFFECTS STC OR TSO DESIGN COMPLIANCE**

**EFFECTIVITY:**

This service letter applies to:

Wipline model 2100 Amphibian Floats S/Ns 21689A thru 21810A and  
2350 Amphibian Floats S/Ns 23099A thru 23140A and older float serial numbers that have had  
hydraulic actuator PN 1002574 installed.

**COMPLIANCE:**

Service letter compliance is mandatory.

**BACKGROUND:**

Corrosion may occur on the threaded connection between the Main Gear Hydraulic  
Retract Actuator and connecting clevis. This service letter and associated kit replaces  
the threaded connection with a stainless steel version of the same part. It also replaces  
the connection hardware with a Clevis Pin instead of a bolted connection.

**COMPLIANCE METHOD:**

Install the parts included in this Service Kit in accordance with the instructions in the  
Technical Data section of this service letter.

**APPROX. SHOP HOURS:**

This service letter will take approximately 1.5 labor hours to complete.

**WARRANTY INFORMATION:**

Parts warranty is included for this modification.

**TECHNICAL DATA:**

Copies of this service letter, associated service kit, float service manual, modification drawing, and float parts manual are available on the website [www.wipaire.com](http://www.wipaire.com).

See drawings below for details on performing this modification.

See Table 1 below for a list of parts and materials applicable to this modification.

For basic Float model maintenance information, see Wipaire applicable Service Manual on website [www.wipaire.com](http://www.wipaire.com).

For basic Float model parts information, see applicable Wipaire Parts Manual on website [www.wipaire.com](http://www.wipaire.com).

**Service Procedures:**

1. Perform the following service procedures after first securing airplane.
2. Jack up the Main Gear until the tire is not in contact with the ground. (refer to Float Service Manual Section 4.0)
3. Remove access cover as shown.
4. Remove Hydraulic Actuator Clevis and connection hardware. Discard hardware.
5. Remove and replace ASH-000WA Threaded Coupler with ASH-316WA.
6. Reuse jam nut on ASH-316WA.
7. Reattach Actuator Clevis to ASH-316WA.
8. Adjust rigging per 2100/2350 Wipaire Float Service Manual Section 5.2. [www.wipaire.com](http://www.wipaire.com)
9. Coat the attach hardware with grease and install as shown.
10. Reinstall the access cover.
11. Lower float on to Main Gear and repeat the service procedure on the opposite float.

TABLE 1			
ITEM	QTY	PART NUMBER	DESCRIPTION
1	1	ASH-316WA	STAINLESS STEEL THREADED COUPLER
2	1	MS20392-4C25	CLEVIS PIN (OLD STYLE CLEVIS)
3	1	MS20392-4C29	CLEVIS PIN (NEW STYLE CLEVIS)
4	2	MS24665-283	COTTER PIN
5	1	NAS1149F0532P	WASHER
6	2	NAS1149F0563P	WASHER

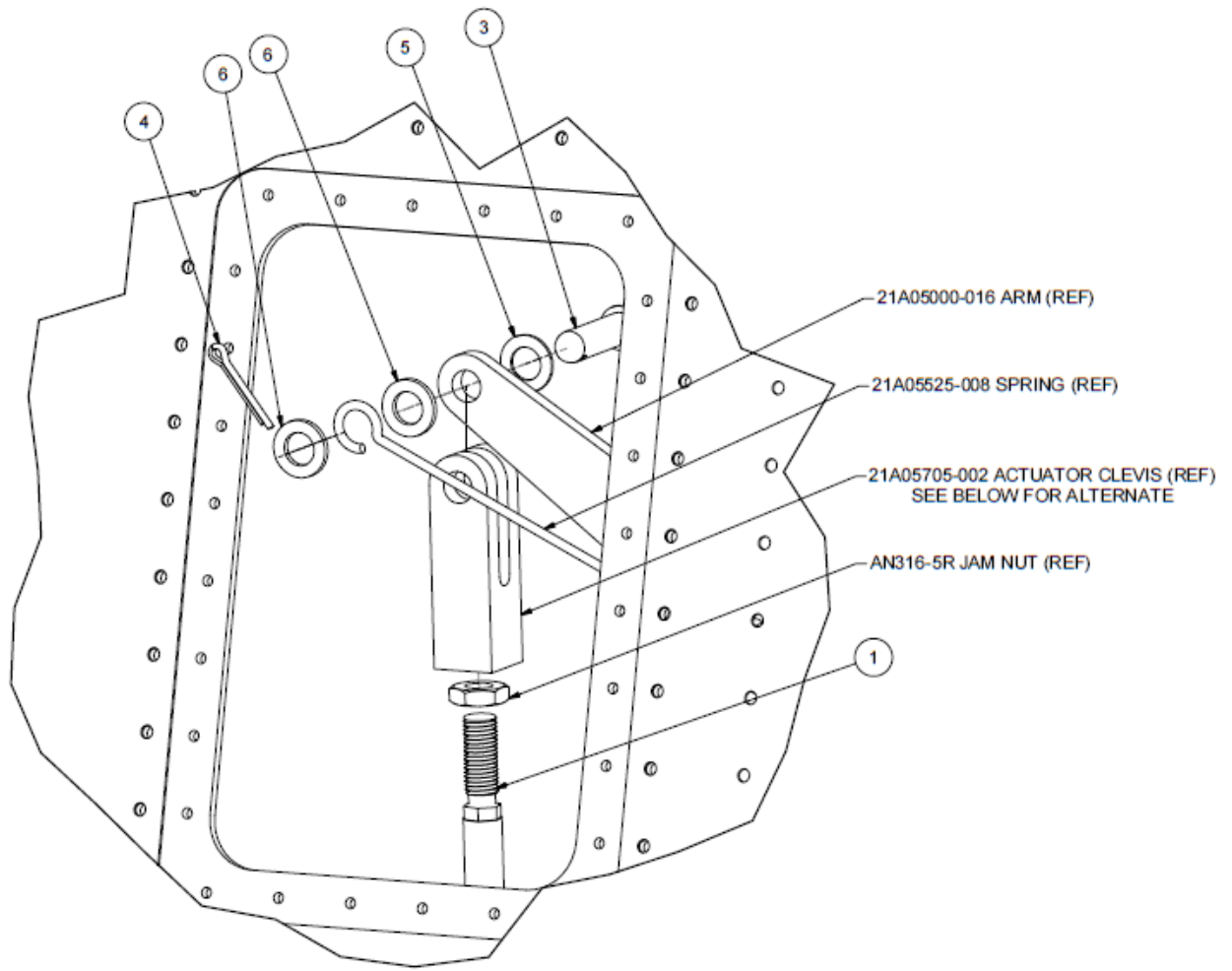

DETAIL A

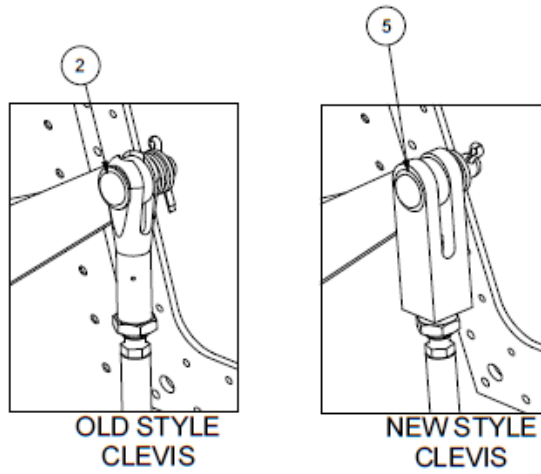

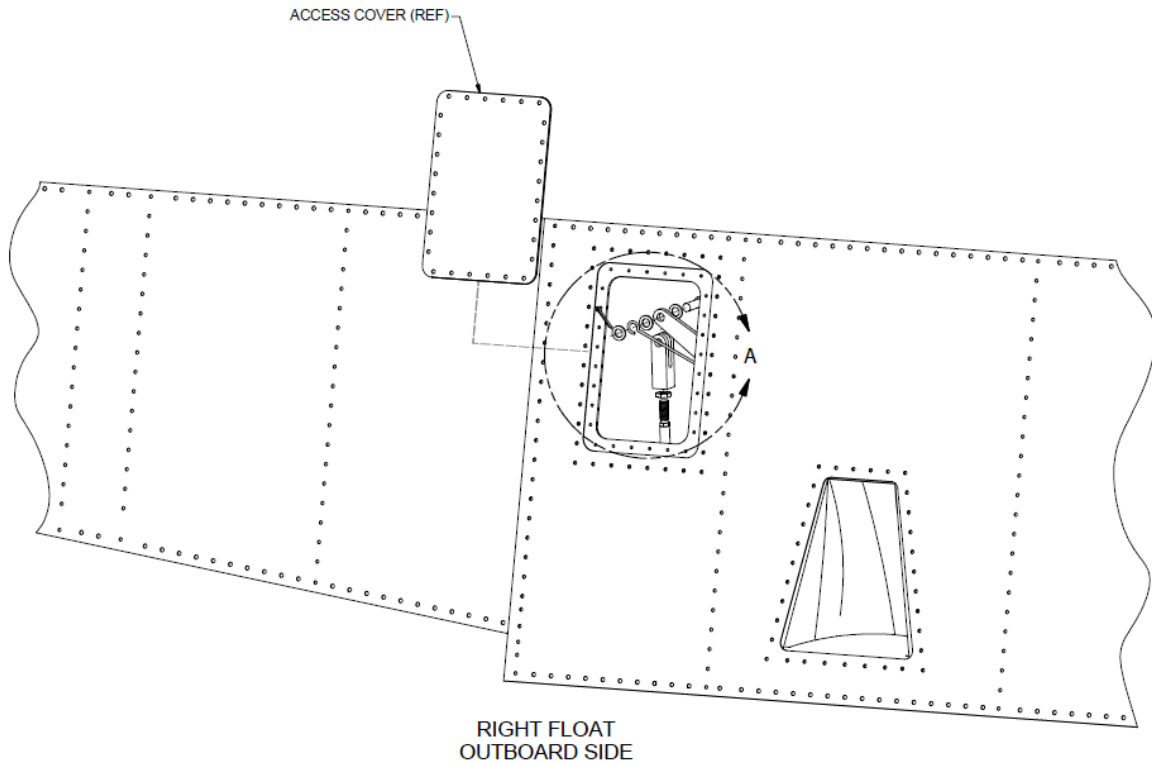

NOTES:

After completion of the instructions in this service letter, make an entry as such in the aircraft logbook in accordance with your local Civil Aviation regulations. Wipaire considers the weight and balance change to be negligible for this modification.

### END ###