



WIPLINE FLOATS • SKIS • MODIFICATIONS • AIRCRAFT SALES
AVIONICS • INTERIOR • MAINTENANCE • PAINT REFINISHING

SERVICE LETTER NUMBER 160

FLOAT ANODE INSTALLATION

By: MAS	Aircraft Makes/Model(s): Cessna 170, 172, 175, 208, 208B, Aviat Husky, Piper PA-12, PA-18, Scout 8GCBC, Maule MX-7-180B, -C, MXT-7-180, MX-7-235, MX-7-420, Quest Kodiak 100, Air Tractor AT-802, AT-802A, DeHavilland DHC-6 Series	Float Model(s): 2100A, 2100S, 2350A, 2350S, 7000A, 8000A, 8750A, 8750S, 10000A, 13000A, 13000S	Note(s): Optional Compliance Service Letter P/N 1008377
Approved: DRH			
Date: 10/27/2022			
Rev: J			

LOG OF REVISIONS

Revision	Description	Date
A	Initial release	1/4/2016
B	Added 8000 applicability and installation instructions, added list of required materials	8/10/2016
C	Changed AN340-416 1/4-20 nut to MS35649-2252 1/4-20 nut for 8000 procedure	5/8/2017
D	Document format update, added 10000A, 13000A, 13000S, 8750S applicability and installation instructions	11/3/2017
E	Added anode afterbody to 13000S floats	4/15/2019
F	Added note in Main Gear Wheel Well Installation.	3/12/2021
G	Updated Kit 1008377-07 and notes, added 13000A float to work instructions.	1/21/2022
H	Added aircraft and float eligibility for 2100 and 2350 floats, updated effectivity. Added work instructions and image for 2100 & 2350 amphibian and straight floats.	5/23/2022
J	Updated instructions and images in Main Gear Wheel Well Installation section. Updated images in Work Instruction - 10000 Amphibian Floats section.	10/27/2022

FAA approval has been obtained for technical data in this publication that affects STC or TSO design compliance.

EFFECTIVITY:

This service letter applies to all floatplanes equipped with model 2100A, 2100S, 2350A, 2350S, 7000A, 8000A, 8750A, 8750S, 10000A, 13000A, 13000S and floats that have not complied with previous revisions of this service letter.

COMPLIANCE:

Compliance with this service letter is optional. The quantity of anodes to be installed is per the installer's discretion.

BACKGROUND:

Floats used in environments that have salty or brackish water will typically show signs of corrosion faster than floats used in fresh water. To reduce the rate of corrosion, sacrificial zinc anodes may be installed on the floats below the water line. This anode installation does not substitute for daily cleaning of the aircraft with fresh water.

COMPLIANCE METHOD:

Install anode kits onto floats per applicable model Work Instruction section of this service letter. Once installed, anodes need to be inspected and cleaned every 100 hours and maintained or replaced as described in each section of the Work Instruction.

APPROXIMATE SHOP HOURS:

See applicable Work Instruction for approximate shop hours.

1700 Henry Ave - Fleming Field (KSGS), South St. Paul, MN 55075

Phone: 651.451.1205 | Fax: 651.457.7858

www.wipaire.com



WIPLINE FLOATS • SKIS • MODIFICATIONS • AIRCRAFT SALES
AVIONICS • INTERIOR • MAINTENANCE • PAINT REFINISHING

WARRANTY INFORMATION:

This service letter does not include any warranty, parts, or labor.

TECHNICAL DATA:

Copies of this service letter, associated service kit, float service manual, and float parts manual are available at www.wipaire.com.

CONTENTS

KIT APPLICABILITY	3
WORK INSTRUCTION - 2100 & 2350 AMPHIBIAN & STRAIGHT FLOATS	4
WATER RUDDER INSTALLATION.....	4
WORK INSTRUCTION - 7000 AND 8750 AMPHIBIAN FLOATS.....	5
WATER RUDDER INSTALLATION.....	5
MAIN GEAR WHEEL WELL INSTALLATION	6
WORK INSTRUCTION - 8750 STRAIGHT FLOATS	8
WATER RUDDER INSTALLATION.....	8
CHINE INSTALLATION	8
WORK INSTRUCTION - 8000 AMPHIBIAN FLOATS	10
WATER RUDDER INSTALLATION.....	10
CARRY-THRU STRAP INSTALLATION	10
WORK INSTRUCTION - 10000 AMPHIBIAN FLOATS	12
WATER RUDDER INSTALLATION.....	12
MAIN GEAR WHEEL WELL INSTALLATION	12
WORK INSTRUCTION - 13000 FLOATS	14
MAIN GEAR WHEEL WELL INSTALLATION - AMPHIBIAN	14
SKEG INSTALLATION - STRAIGHT FLOATS.....	15
ZINC ANODE DOUBLER INSTALLATION - STRAIGHT & AMPHIBIAN FLOATS.....	16

1700 Henry Ave - Fleming Field (KSGS), South St. Paul, MN 55075

Phone: 651.451.1205 | Fax: 651.457.7858

www.wipaire.com



WIPLINE FLOATS • SKIS • MODIFICATIONS • AIRCRAFT SALES
AVIONICS • INTERIOR • MAINTENANCE • PAINT REFINISHING

KIT APPLICABILITY

KIT PART NUMBER	KIT DESCRIPTION	FLOAT MODEL APPLICABILITY
1008377-01	Kit, 7000A, 8750A Wheel Well Anode - Float Set	7000A, 8750A
1008377-02	Kit, All Models - Water Rudder Anode - Float Set	All Models (excluding 13000A, 13000S, 7000A composite rudders)
1008377-03	Kit, 8000A Wheel Well Anode - Float Set	8000A
1008377-04	Kit, 8750S Chine Anode - Float Set	8750S
1008377-05	Kit, 10000A, 13000A Wheel Well Anode - Float Set	10000A, 13000A
1008377-06	Kit, 13000S Skeg Anode - Float Set	13000S
1008377-07	Kit, 13000 Zinc Anode Doubler - Float Set	13000S, 13000A

NOTES:

- To complete an installation (water rudder locations and wheel well vicinity) for one set of floats, a total of 2 kits will be required. (Example: To complete an 8750A float set, (1) 1008377-02 kit and (1) 1008377-01 kit will need to be ordered.)
- Do not install anodes on 7000A model float water rudders if the composite water rudders are installed.



WIPLINE FLOATS • SKIS • MODIFICATIONS • AIRCRAFT SALES
AVIONICS • INTERIOR • MAINTENANCE • PAINT REFINISHING

WORK INSTRUCTION - 2100 & 2350 AMPHIBIAN & STRAIGHT FLOATS

Showing left float installation. Mirror installation for right float

RECOMMENDED INSTALLATION MATERIALS PER FLOAT SET - MODEL 2100 & 2350 FLOATS

ITEM	QTY	PART NUMBER	DESCRIPTION
1	2	CMR01 (or equivalent)	1 7/8" Anode with Provided 10-32 Hardware

* Order Kit 1008377-02 or CMR01 (or equivalent) for water rudder installation.

WATER RUDDER INSTALLATION

1. Identify the location that the anode will be installed. Reference figure below. Make sure that the anode will be below the water line with the rudder water down and when the floats are in the water with a minimally loaded plane.
2. Position CMR01 (or equivalent) anode in location of installation and outline the anode mounting surface on both sides.
3. Remove any paint from the surface previously marked.

NOTE: The anode needs to be mounted to bare metal so that it can complete the electrical circuit.

4. Drill a 3/32" hole in center of the marked surface on the water rudder.
5. Install anode to each side of the water rudder using provided hardware as shown.

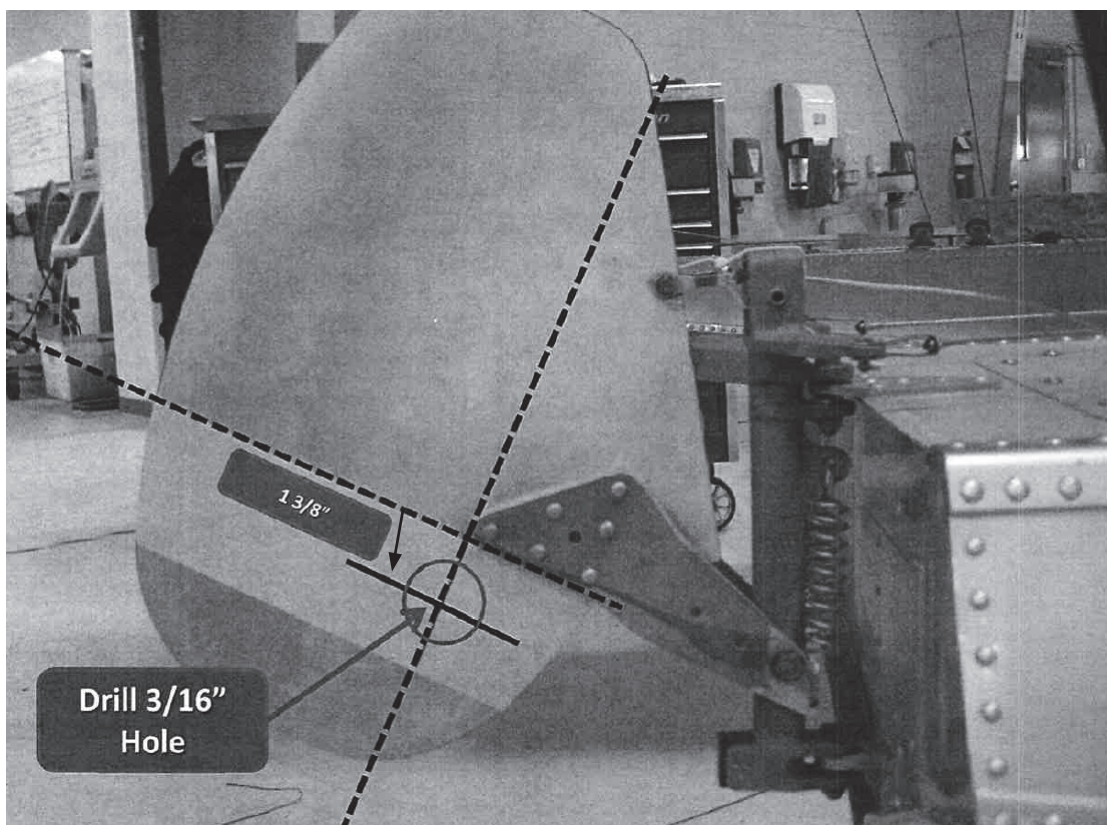

NOTE: Do not paint the anodes after installation. They must remain unfinished.

6. Trim bolt shaft if needed so no more than about 3 threads protrude past the anode.
7. Routinely clean and inspect the anodes and surrounding areas for signs of corrosion. Replace anodes when they decrease to one-third their original size.



WIPLINE FLOATS • SKIS • MODIFICATIONS • AIRCRAFT SALES
AVIONICS • INTERIOR • MAINTENANCE • PAINT REFINISHING

WORK INSTRUCTION - 7000 AND 8750 AMPHIBIAN FLOATS

Showing left float installation. Mirror installation for right float

RECOMMENDED INSTALLATION MATERIALS PER FLOAT SET - MODEL 7000A AND 8750A FLOATS

ITEM	QTY	PART NUMBER	DESCRIPTION
1	2	CMR01 (or equivalent)	1 7/8" Anode with Provided 10-32 Hardware
2	2	CMR02 (or equivalent)	2 13/16" Anode with Provided 1/4-20 Hardware
3	2	1008367	Anode Bracket
4	10	AN526-632R6	Screw

Two different size anodes are offered for installation:

- CMR01 (or equivalent), outside diameter of 1 7/8", weight of 0.28 lb., is recommended for water rudder installation
- CMR02 (or equivalent), outside diameter of 2 13/16", weight of 0.94 lb., is recommended for installation in the main gear wheel well

WATER RUDDER INSTALLATION

Approximate water rudder installation time on 1 float: 1 hour

1. Identify the location that the anode will be installed. Make sure that the anode will be below the water line with the rudder water down and when the floats are in the water with a minimally loaded plane
2. Position CMR01 (or equivalent) anode in location of installation and outline the anode mounting surface on both sides
3. Remove any paint from the surface previously marked

NOTE: The anode needs to be mounted to bare metal so that it can complete the electrical circuit

4. Drill a 7/32" hole in center of the marked surface on the water rudder
5. Install anode to each side of the water rudder using provided hardware as shown

NOTE: Do not install anodes on 7000A model float water rudders if the composite water rudders are installed. Reference service letter 135

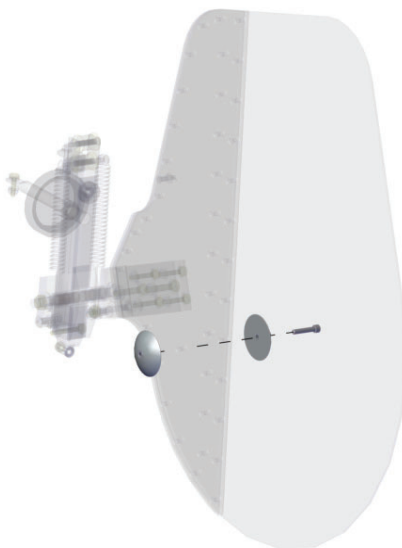

NOTE: Do not paint the anodes after installation. They must remain unfinished

6. Trim bolt shaft if needed so no more than about 3 threads protrude past the anode
7. Routinely clean and inspect the anodes and surrounding areas for signs of corrosion. Replace anodes when they decrease to one-third their original size

Approximate main gear wheel well installation time on 1 float: 1 hour

MAIN GEAR WHEEL WELL INSTALLATION

Note: For an alternate location of anode installation on the carry through strap, see 8000 amphibian section below. (Purchase part numbers from that section).

1. Identify the location on the left lower forward corner of the wheel access cover in which the anode will be installed. Make sure that the anode will be below the water line when the floats are in the water with a minimally loaded plane.

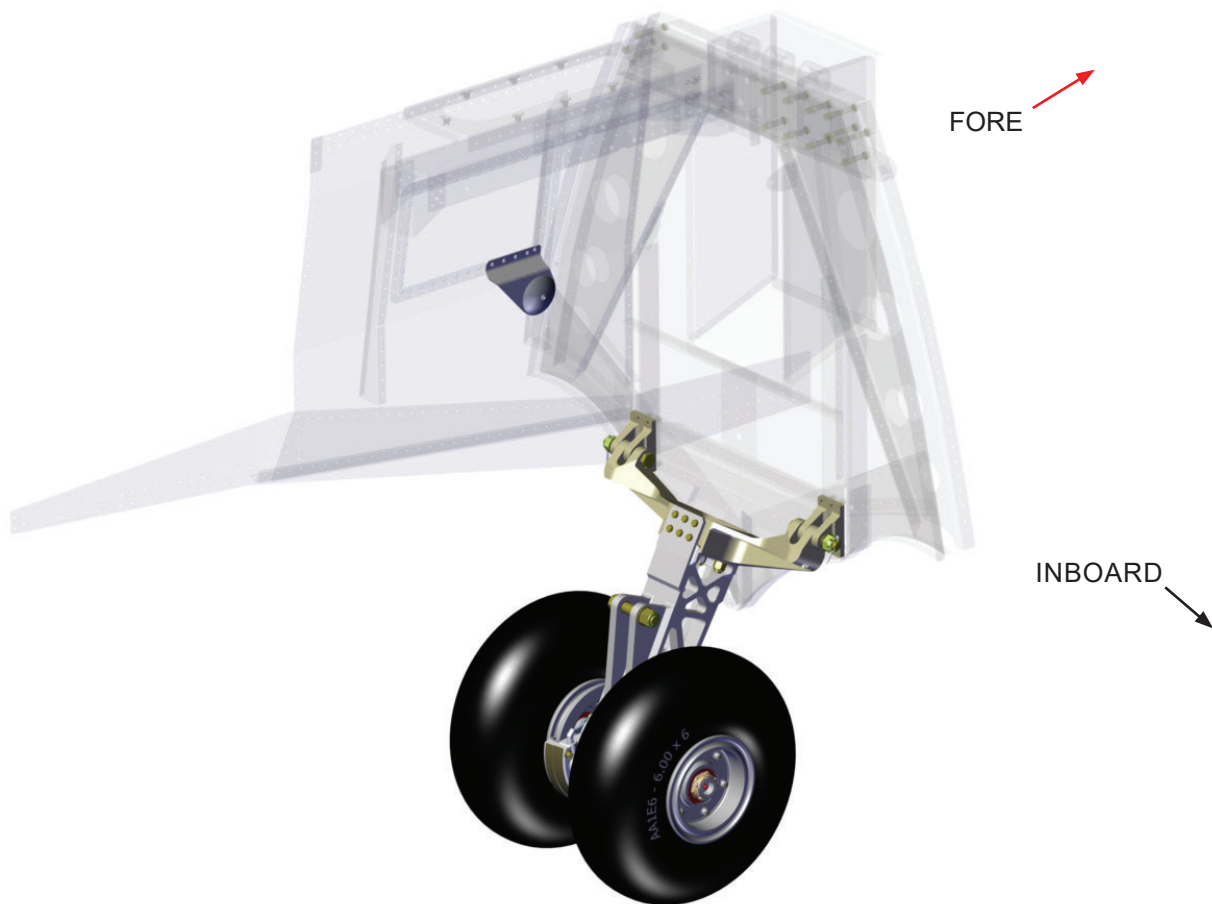

L/H FLOAT SHOWN

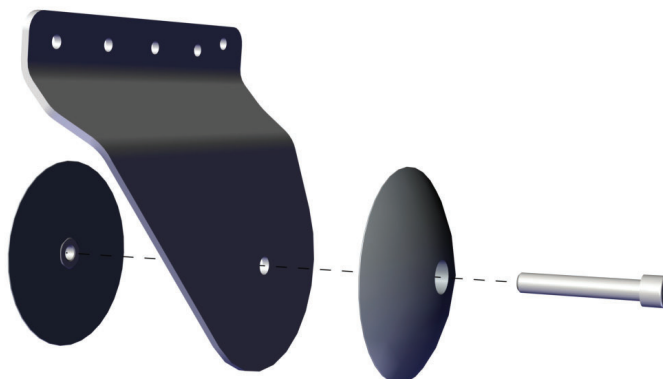

2. Assemble CMR02 (or equivalent) anode to bracket as shown.

L/H FLOAT SHOWN

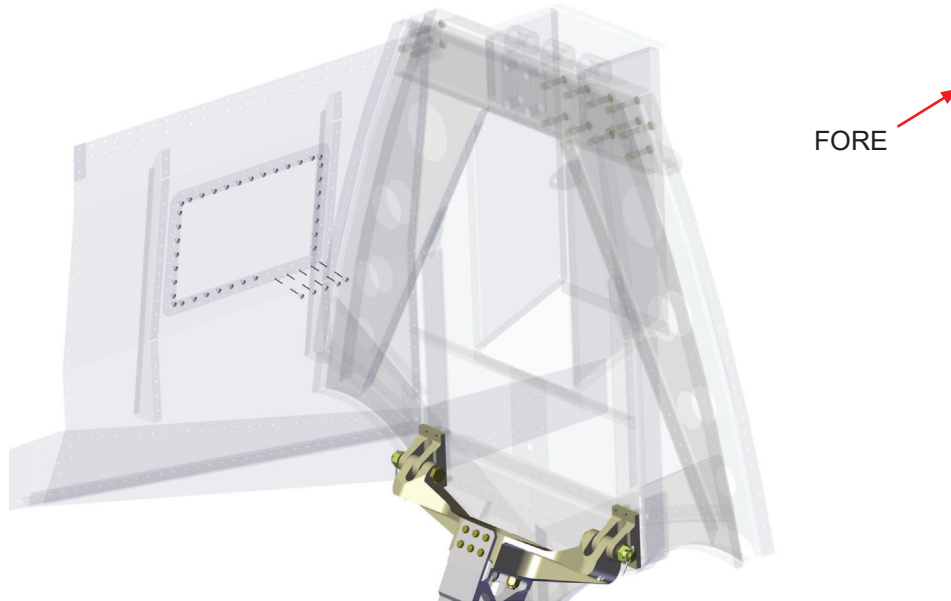

3. Remove the existing (5) AN526-632R4 screws on the left lower forward corner of the wheel access cover as shown.
4. Install bracket with anode as shown with (5) AN526-632R6 screws.

L/H FLOAT SHOWN

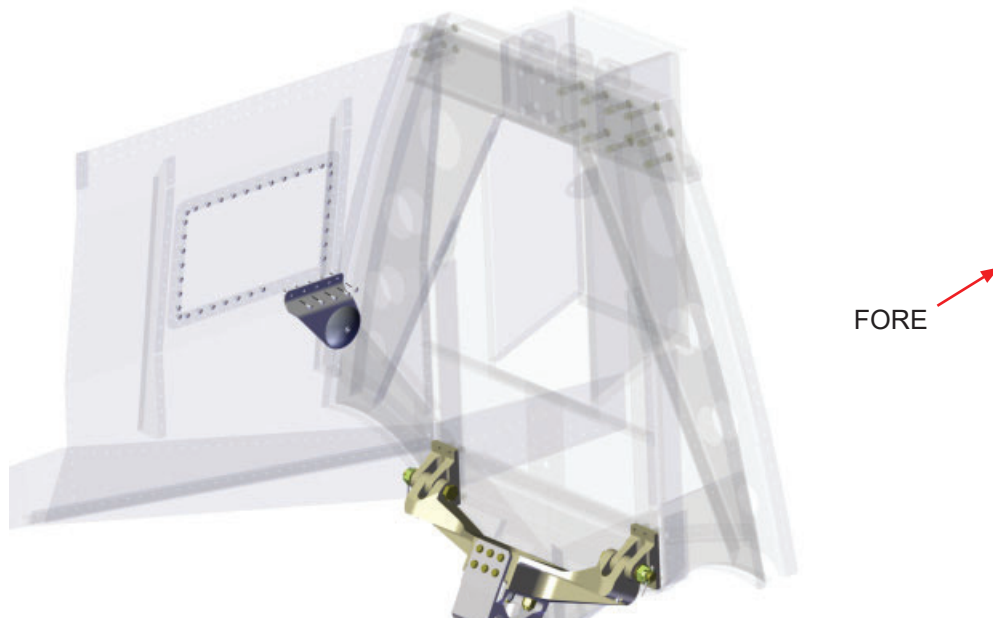

NOTE: Do not paint the anodes after installation. They must remain unfinished.

5. Seal the access panel mounting hardware after installation.
6. Confirm that the anodes are below the water line when the floats are in the water with a minimally loaded plane.
7. Routinely clean and inspect the anodes and surrounding areas for signs of corrosion. Replace anodes when they decrease to one-third their original size.



WIPLINE FLOATS • SKIS • MODIFICATIONS • AIRCRAFT SALES
AVIONICS • INTERIOR • MAINTENANCE • PAINT REFINISHING

WORK INSTRUCTION - 8750 STRAIGHT FLOATS

Showing left float installation. Mirror installation for right float

RECOMMENDED INSTALLATION MATERIALS PER FLOAT SET - MODEL 8750S FLOATS

ITEM	QTY	PART NUMBER	DESCRIPTION
1	2	CMR01 (or equivalent)	1 7/8" Anode with Provided 10-32 Hardware
2	2	CMR02 (or equivalent)	2 13/16" Anode with Provided 1/4-20 Hardware
3	4	13S01150-213	Anode Washer

Two different size anodes are offered for installation:

- CMR01 (or equivalent), outside diameter of 1 7/8", weight of 0.28 lb., is recommended for water rudder installation
- CMR02 (or equivalent), outside diameter of 2 13/16", weight of 0.94 lb., is recommended for installation on the inboard chine doubler

WATER RUDDER INSTALLATION

1. Use the [7000 and 8750 amphibian floats water rudder installation section](#) as reference to install the water rudder anode on the 8750S water rudder

CHINE INSTALLATION

Approximate chine installation time on 1 float: 1 hour

1. Identify the location on the inboard chine doubler in which the anode will be installed. Make sure that the anode will be below the water line when the floats are in the water with a minimally loaded plane

NOTE: Anode may be installed on the inboard chine if preferred. Instruction shown for installation on the outboard chine only.

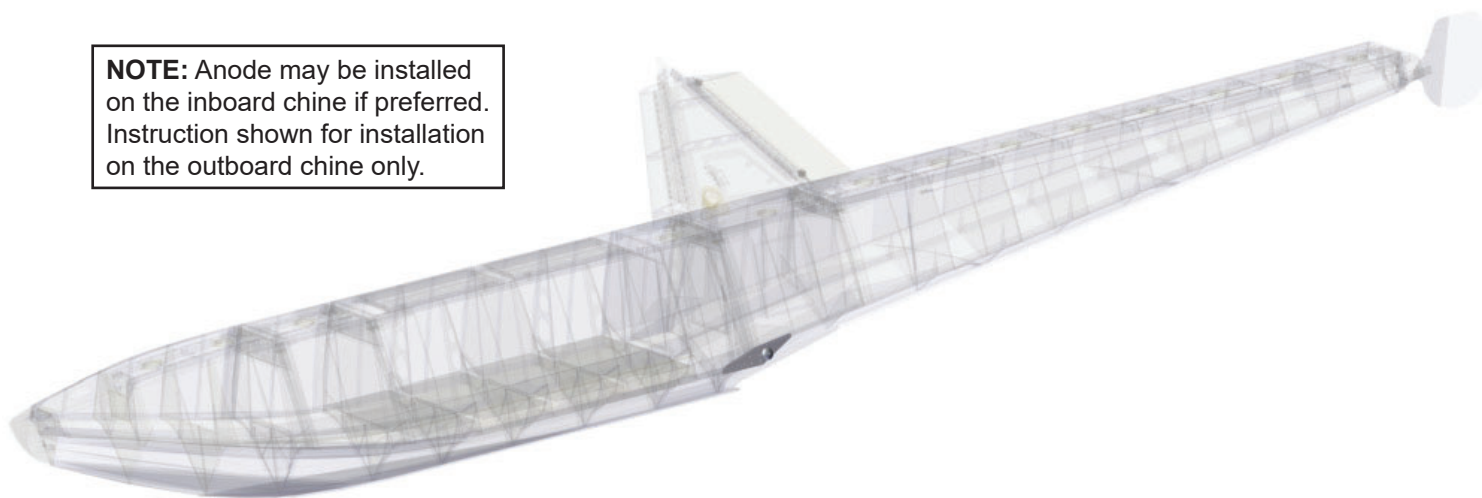

NOTE: The anode may slightly hang below the chine doubler. The overhanging material may be ground away later in the instruction

2. Position CMR02 (or equivalent) anode on the outboard surface of the chine doubler. Outline the anode mounting surface on the outboard surface only
3. Remove any paint from the surface previously marked

NOTE: The anode needs to be mounted to bare metal so that it can complete the electrical circuit

4. Drill a 1/4" hole in center of the marked surface on the chine doubler

5. Install anode and anode washers to each side of the chine doubler using provided hardware as shown

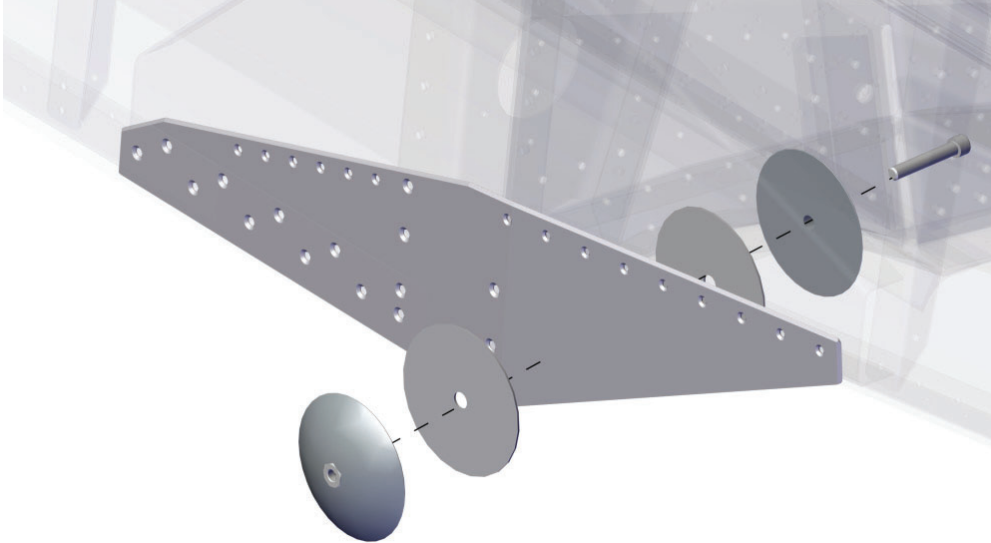

NOTE: Anode may be installed in the opposite direction if preferred so the bolt is inserted from the outboard side

6. Trim bolt shaft if needed so no more than about 3 threads protrude past the anode
7. If preferred, grind anodes and anode washers so no excess material is hanging below the chine

NOTE: Do not paint the anodes after installation. They must remain unfinished

8. Confirm that the anodes are below the water line when the floats are in the water with a minimally loaded plane
9. Routinely clean and inspect the anodes and surrounding areas for signs of corrosion. Replace anodes when either washer begins to show signs of corrosion



WIPLINE FLOATS • SKIS • MODIFICATIONS • AIRCRAFT SALES
AVIONICS • INTERIOR • MAINTENANCE • PAINT REFINISHING

WORK INSTRUCTION - 8000 AMPHIBIAN FLOATS

Showing left float installation. Mirror installation for right float

RECOMMENDED INSTALLATION MATERIALS PER FLOAT SET - MODEL 8000 FLOATS

ITEM	QTY	PART NUMBER	DESCRIPTION
1	2	CMR01 (or equivalent)	1 7/8" Anode with Provided 10-32 Hardware
2	1	CMR02 (or equivalent)	2 13/16" Anode with Provided 1/4-20 Hardware
3	2	13S01150-213	Anode Washer
4	2	AN970-4 1/4-20	Wide Area Washer
5	1	NAS1352-422 1/4-20	Socket Head Cap Screw
6	1	MS35649-2252 1/4-20	Nut

Two different size anodes are offered for installation:

- CMR01 (or equivalent), outside diameter of 1 7/8", weight of 0.28 lb., is recommended for rudder installation
- CMR02 (or equivalent), outside diameter of 2 13/16", weight of 0.94 lb., is recommended for installation on the outboard carry-thru strap of the main gear wheel well

WATER RUDDER INSTALLATION

1. Use the [7000 and 8750 amphibian floats water rudder installation section](#) as reference to install the water rudder anode on the 8000A water rudder

CARRY-THRU STRAP INSTALLATION

Approximate carry-thru strap installation time on 1 float: 1 hour

1. Identify the location on the outboard surface of the inboard carry-thru strap in which the anode will be installed. Make sure that the anode will be below the water line when the floats are in the water with a minimally loaded plane

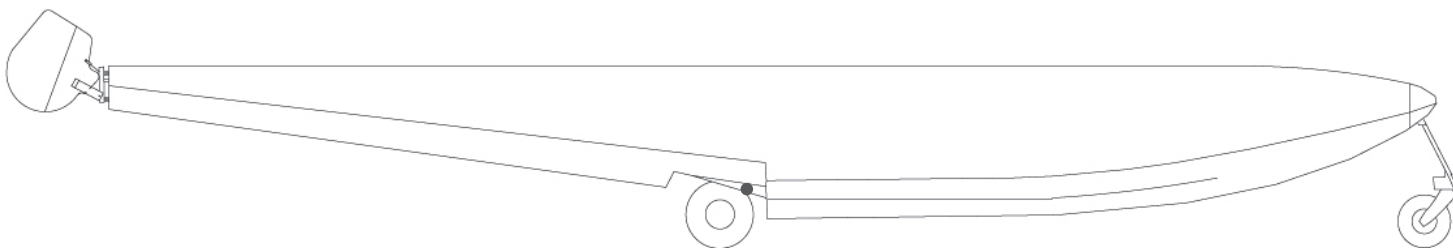

NOTE: The anode may slightly hang below the carry-thru strap. The overhanging material may be ground away later in the instruction

NOTE: Anode will only be installed on outboard surface of the inboard carry-thru strap

2. Disassemble CMR02 (or equivalent) completely

3. Position CMR02 (or equivalent) anode on the outboard surface of the inboard carry-thru strap and verify there will be adequate clearance between the anode mounting hardware and the main landing gear. Outline the anode mounting surface on the outboard surface only

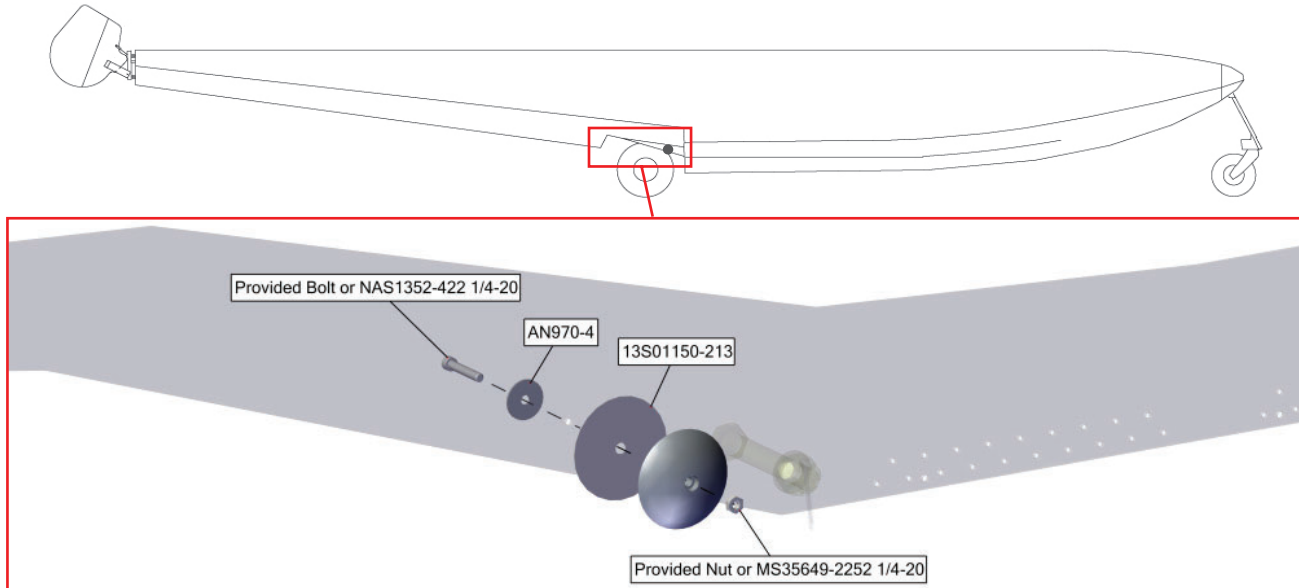

4. Remove any paint from the surface previously marked

NOTE: The anode needs to be mounted to bare metal so that it can complete the electrical circuit

5. Drill a 1/4" hole in center of the marked surface on the carry-thru strap
6. Install 1 of the anodes and an anode washer to the outboard surface of the carry-thru strap as shown

NOTE: Verify the anode washer is directly inbetween the anode and the carry-thru strap

7. Trim bolt shaft if needed so no more than about 3 threads protrude past the anode
8. If preferred, grind anode and anode washer so no excess material is hanging below the carry-thru strap



NOTE: Do not paint the anodes after installation. They must remain unfinished

9. Confirm that the anodes are below the water line when the floats are in the water with a minimally loaded plane
10. Routinely clean and inspect the anodes and surrounding areas for signs of corrosion. Replace anodes when either washer begins to show signs of corrosion



WIPLINE FLOATS • SKIS • MODIFICATIONS • AIRCRAFT SALES
AVIONICS • INTERIOR • MAINTENANCE • PAINT REFINISHING

WORK INSTRUCTION - 10000 AMPHIBIAN FLOATS

Showing left float installation. Mirror installation for right float

RECOMMENDED INSTALLATION MATERIALS PER FLOAT SET - MODEL 10000A FLOATS

ITEM	QTY	PART NUMBER	DESCRIPTION
1	2	CMR01 (or equivalent)	1 7/8" Anode with Provided 10-32 Hardware
2	2	CMR02 (or equivalent)	2 13/16" Anode with Provided 1/4-20 Hardware
3	2	1009461	Anode Bracket
4	2	MS16997-62	Socket Head Cap Screw

Two different size anodes are offered for installation:

- CMR01 (or equivalent), outside diameter of 1 7/8", weight of 0.28 lb., is recommended for water rudder installation
- CMR02 (or equivalent), outside diameter of 2 13/16", weight of 0.94 lb., is recommended for installation in the main gear wheel well

WATER RUDDER INSTALLATION

1. Use the [7000 and 8750 amphibian floats water rudder installation section](#) as reference to install the water rudder anode on the 10000A water rudder

MAIN GEAR WHEEL WELL INSTALLATION

Approximate main gear wheel well installation time on 1 float: 3 hours

1. Identify the location on the bulkhead 17 slide tube attach angle in which the anode will be installed. Make sure that the anode will be below the water line when the floats are in the water with a minimally loaded plane

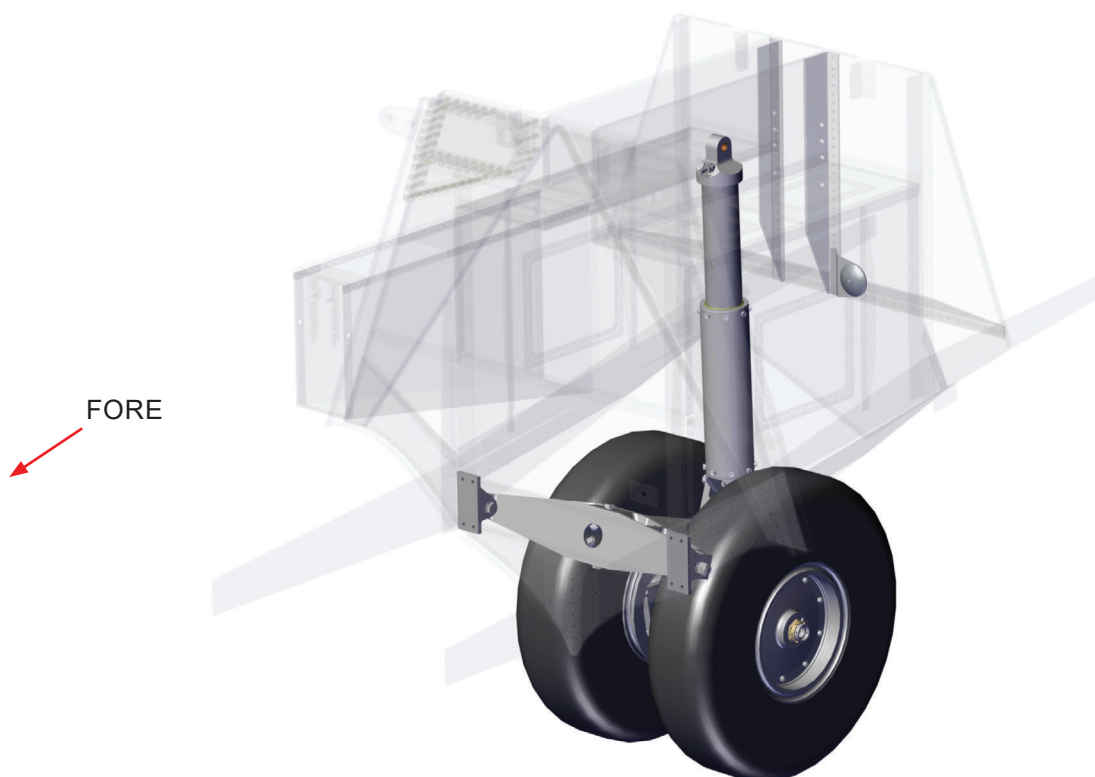

2. Assemble CMR02 (or equivalent) anode to bracket as shown using MS16997-62 socket head screw

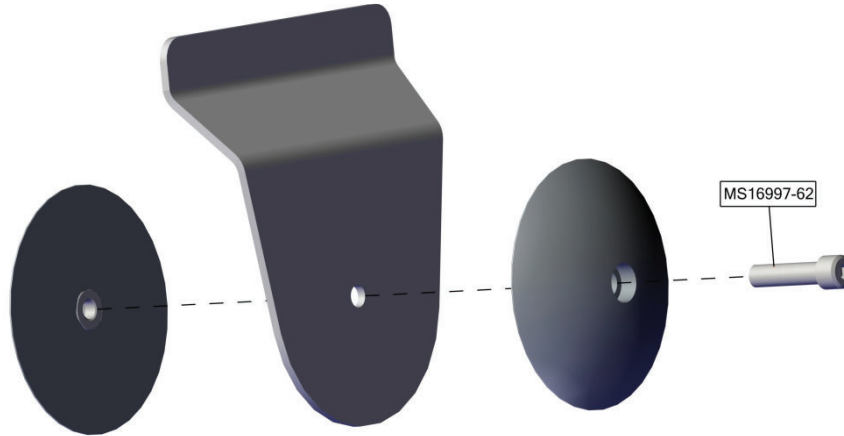

3. Remove small top deck inspection cover aft of bulkhead 17
4. Align bracket and attached CMR02 (or equivalent) anode on bulkhead 17 slide tube attach angle and backdrill through bracket and 5 rivets as shown



5. Rivet bracket into place

NOTE: Do not paint the anodes after installation. They must remain unfinished

6. Reinstall top deck inspection cover
7. Confirm that the anodes are below the water line when the floats are in the water with a minimally loaded plane
8. Routinely clean and inspect the anodes and surrounding areas for signs of corrosion. Replace anodes when they decrease to one-third their original size



WIPLINE FLOATS • SKIS • MODIFICATIONS • AIRCRAFT SALES
AVIONICS • INTERIOR • MAINTENANCE • PAINT REFINISHING

WORK INSTRUCTION - 13000 FLOATS

Showing left float installation. Mirror installation for right float

RECOMMENDED INSTALLATION MATERIALS PER FLOAT SET - MODEL 13000A FLOATS

ITEM	QTY	PART NUMBER	DESCRIPTION
1	2	CMR02 (or equivalent)	2 1 ³ / ₁₆ " Anode with Provided 1/4-20 Hardware
2	2	1009461	Anode Bracket
3	2	MS16997-62	Socket Head Cap Screw

One size anode is offered for installation:

- CMR02 (or equivalent), outside diameter of 2 1³/₁₆", weight of 0.94 lb., is recommended for installation in the main gear wheel well

MAIN GEAR WHEEL WELL INSTALLATION - AMPHIBIAN

1. Use the [10000 amphibian floats main gear wheel well installation section](#) as reference to install the main gear wheel well anode in the 13000A main gear wheel well

One size anode is offered for installation:

Showing left float installation. Mirror installation for right float

RECOMMENDED INSTALLATION MATERIALS PER FLOAT SET - MODEL 13000S FLOATS

ITEM	QTY	PART NUMBER	DESCRIPTION
1	2	CMR02 (or equivalent)	2 1 ³ / ₁₆ " Anode with Provided 1/4-20 Hardware
2	4	13S01150-213	Anode Washer

- CMR02 (or equivalent), outside diameter of 2 1³/₁₆", weight of 0.94 lb., is recommended for installation on the skag

SKAG INSTALLATION - STRAIGHT FLOATS

Approximate skag installation time on 1 float: 1 hour

1. Identify the location on the skag in which the anode will be installed and position CMR02 (or equivalent) anode on the skag where shown. Make sure that the anode will be below the water line when the floats are in the water with a minimally loaded plane
2. Outline the anode mounting surface on both sides of the skag

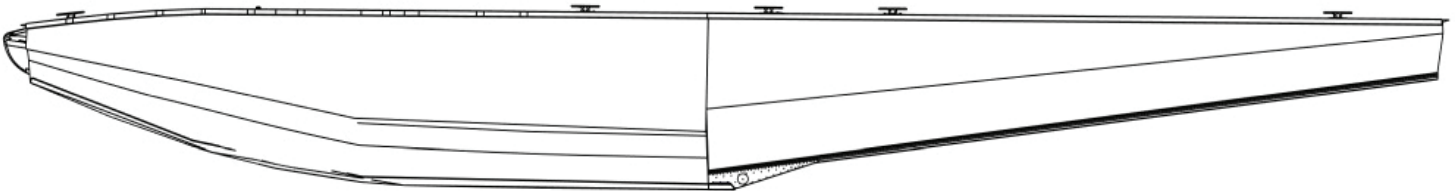

3. Remove any paint from the surface previously marked

NOTE: The anode needs to be mounted to bare metal so that it can complete the electrical circuit

4. Drill a 1/4" hole in center of the marked surface on the skag
5. Install anode to skag as shown

NOTE: Verify an anode washer is directly in between the anode and the skag on both sides. Modify washer around rivets if needed so anode washer is flush with skag

NOTE: Do not paint the anodes after installation. They must remain unfinished

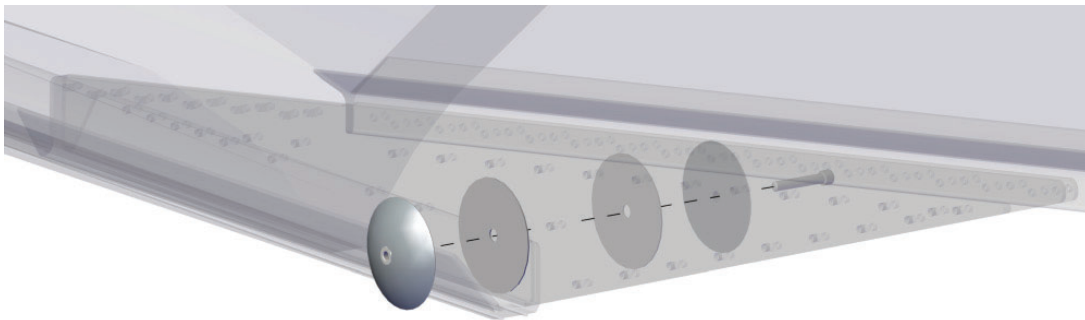

6. Trim bolt shaft if needed so no more than about 3 threads protrude past the anode
7. Routinely clean and inspect the anodes and surrounding areas for signs of corrosion. Replace anodes when either washer begins to show signs of corrosion



WIPLINE FLOATS • SKIS • MODIFICATIONS • AIRCRAFT SALES
AVIONICS • INTERIOR • MAINTENANCE • PAINT REFINISHING

Showing left float installation. Mirror installation for right float

RECOMMENDED INSTALLATION MATERIALS PER FLOAT SET MODEL 13000S/13000A FLOATS

ITEM	QTY	PART NUMBER	DESCRIPTION
1	1	13S01150-211	Doubler, Zinc Anode, Right Float, 13000
2	2	13S01150-212	Doubler, Zinc Anode Left Float, 13000
3	1	CMR02	2 $1\frac{3}{16}$ " Anode with Provided $\frac{1}{4}$ -20 Hardware
4	2	13S01150-213	Washer Anode
5	2	AN4-5A	Bolt
6	2	NAS1149D0463J	Washer
7	2	MS21083N4	Nut

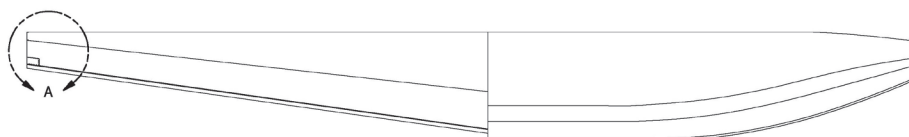

13000 STRAIGHT
LH SIDE
SCALE 1/25

Note: Amphib Similar

ZINC ANODE DOUBLER INSTALLATION - STRAIGHT & AMPHIBIAN FLOATS

Note: See Detail A below for reference on left float.

1. Match drill existing holes in sister keel to 13S01150-212 doubler and flush rivet.
2. Drill existing #30 holes in 13S01150-212 doubler through bottom skin and flush rivet.
3. Use hole finder to locate holes in #24 (13S01000-207) bulkhead and flush rivet.
4. Add 0.32 bolt hole to install zinc anode.
5. Flush rivet before riveting 13S01150-212 doubler to bottom skin.
6. Seal around doubler with PR-1422 or equivalent.
7. Install anode washer and 1/2 of anode with included hardware.
8. Paint bare doubler. **Warning: Do not paint the anode.**
9. Seal hardware inside of doubler to ensure compartment is watertight.
10. After sealant dries, confirm compartment is watertight.
11. Repeat process as shown for 13S001150-211 doubler for the right float.

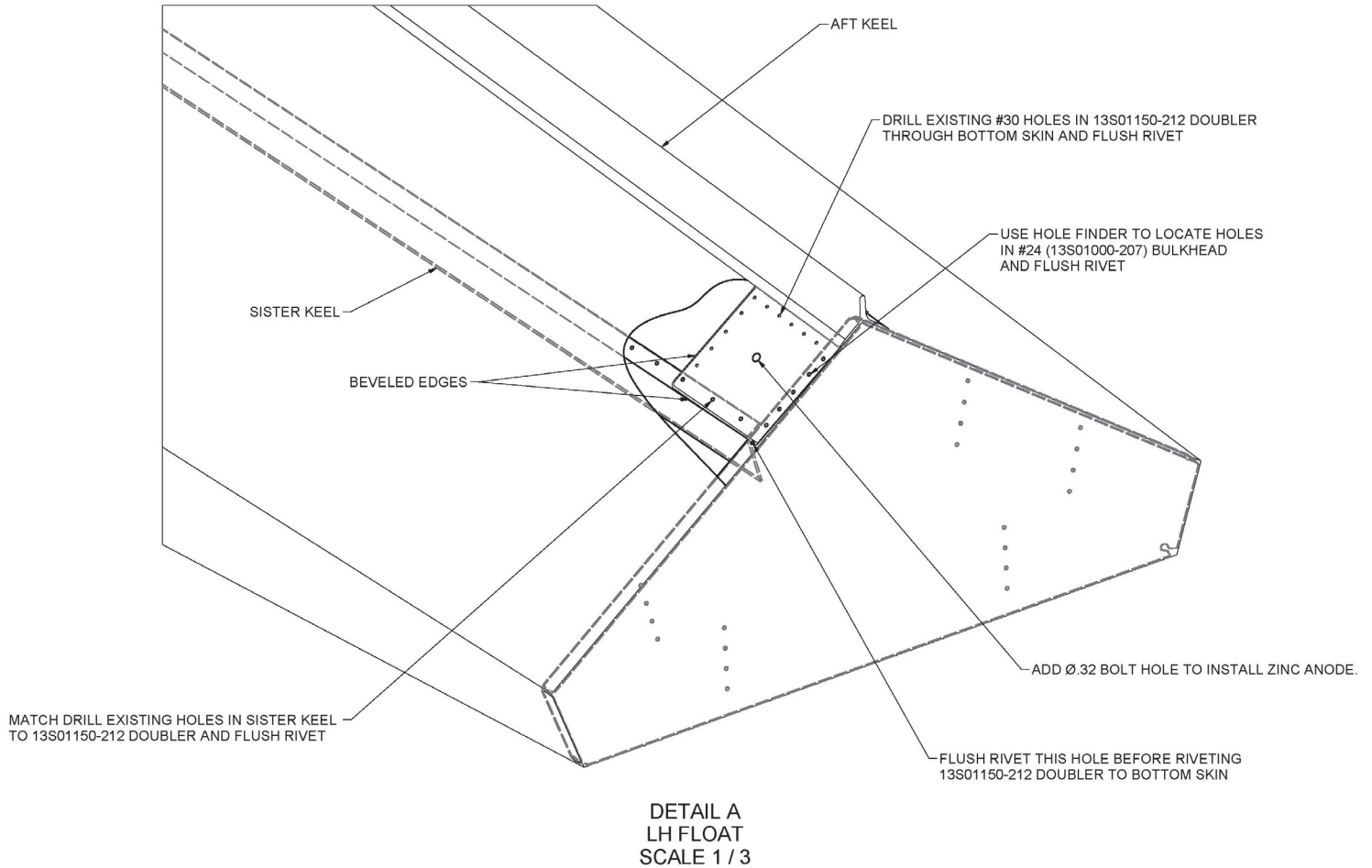

NOTES:

1. Upon completion of inspection, enter information in Aircraft Logbook for completion of Wipaire Service Letter 160