



WIPLINE FLOATS • SKIS • MODIFICATIONS • AIRCRAFT SALES
AVIONICS • INTERIOR • MAINTENANCE • PAINT REFINISHING

SERVICE LETTER 267

Fire Boss (Two Seater) – Convert Ballast Plates to Steel

Aircraft Makes/Model(s):	Float Model(s):	Compliance: Optional	By: MAS
Air Tractor AT-802 (Two Seater)	10000A	Part Number: 1012712	Approved: DRH
		Date: 1/15/2025	Revision: A

LOG OF REVISIONS

Revision	Description	Date
A	Initial release	1/15/2025

FAA approval has been obtained for technical data in this publication that affects STC or TSO design compliance.

EFFECTIVITY:

This service letter applies to all Wipline model 10000 amphibian floats installed per STC SA01795CH on AT-802 (two seater) aircraft. Steel ballast plates became standard for production in 2025. Review Figure 1 to determine the equipped configuration.

COMPLIANCE:

Compliance is optional.

BACKGROUND:

Earlier versions of both removeable and fixed ballast plates were made from lead, which presents potential health hazards and, in some jurisdictions, regulatory challenges. This service letter provides the option of removing all lead ballast plates and replacing them with steel versions. This service letter also describes adjustments to the ballast holder assemblies in order to accept the larger volume of the steel plates. The weight of these parts remain the same.

COMPLIANCE METHOD:

Remove parts as shown in the Work Instructions section of this service letter.

APPROXIMATE SHOP HOURS:

Performing the work instructions will take approximately 3 labor hours per float set to complete.

WARRANTY INFORMATION:

This service letter does not include warranty for labor or parts.

TECHNICAL DATA:

Copies of this service letter, associated service kit (if applicable), float service manual, and float parts manual are available at www.wipaire.com.

1700 Henry Ave - Fleming Field (KSGS), South St. Paul, MN 55075

Phone: 651.451.1205 | Fax: 651.457.7858

www.wipaire.com

ITEMS PROVIDED IN SERVICE KIT 1012712-01 (2 REQUIRED PER FLOAT SET)			
ITEMS MAY BE ORDERED INDIVIDUALLY AS NEEDED			
ITEM	QTY	PART NUMBER	DESCRIPTION
1	3	1012696	BALLAST PLATE, REMOVEABLE, STEEL
2	1	1012697	BALLAST PLATE, FIXED, .75IN, STEEL
3	1	1012699	BALLAST PLATE, FIXED, 1.5IN, STEEL
4	8	1012700	SPACER, BALLAST, RIB
5	2	1012701	SPACER, BALLAST, RIB, BACK
6	30	AN526-832R12	SCREW, MACHINE, TRUSS HEAD
7	8	AN3-24A	BOLT, 10-32, 2.125 GRIP, UNDRILLED, STEEL
8	8	AN3-27A	BOLT, 10-32, 2.5 GRIP, UNDRILLED, STEEL

Work Instructions

NOTE: These instructions are written for a single float but may be performed on both simultaneously.

1. Position and prepare aircraft for safe maintenance.
2. Add spacers and exchange ballast plates at fwd ballast assembly. Refer to Figure 1.

NOTE: Service Letter 209 provides for alternate configurations of fixed ballast and may be performed in conjunction with these instructions.

- a. Remove retaining pin and the removeable lead ballast plates (yellow), if present.
 - b. Temporarily remove forward ballast assembly from float by removing (14) pan head screws and (6) countersunk screws. Retain this hardware.
 - c. Remove the fixed lead ballast plates from bottom of assembly by removing (16) AN3 bolts.
 - d. Remove (15) AN526 screws and set top plate aside.
 - e. Insert spacers (items 4, 5) and reinstall top plate using longer AN526 screws (item 6) and blue Loctite (or equivalent).
 - f. Install fixed steel ballast plates (items 2, 3) using AN3 bolts (items 7, 8) and red Loctite, or equivalent. Install the -27A bolts at the two inner rib locations and the -24A bolts at the outer locations.
 - g. Reinstall fwd ballast assembly to float with the hardware removed in step 2a.
 - h. Insert removeable steel ballast plates (orange, item 1) as appropriate for the desired weight and balance. Note the "TOP" mark on these plates. Insert retaining pin.
3. Add spacers to aft ballast assembly. Refer to Figure 2:
 - a. If removeable lead ballast plates (yellow) are present at the aft location, remove retaining pin and plates.
 - b. Remove (15) AN526 screws and set top plate aside.
 - c. Insert spacers (items 4, 5) and reinstall top plate using longer AN526 screws (item 6) and blue Loctite (or equivalent).
 - d. Insert removeable steel ballast plates (orange, item 1) as appropriate for the desired weight and balance. Note the "TOP" mark on these plates. Insert retaining pin, if removed.

LEAD BALLAST ASSEMBLY, FWD - ITEMS TO REMOVE

NOTE: SL 209 DESCRIBES ALTERNATE CONFIGURATION, NOT SHOWN HERE

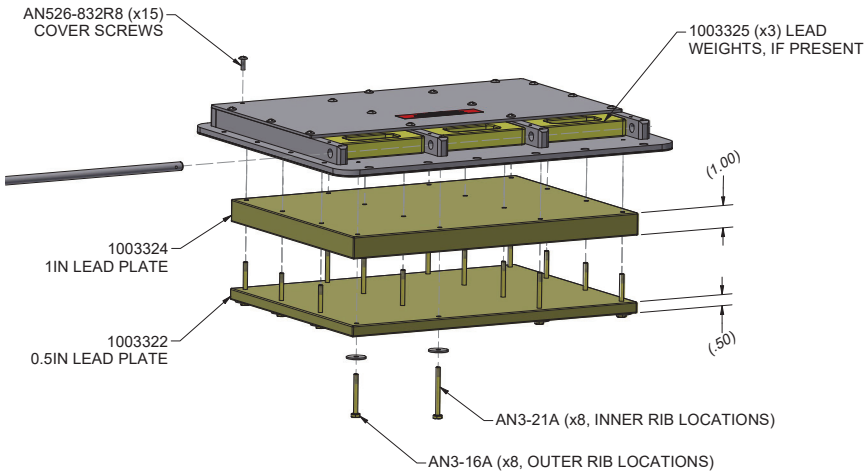

LEAD PLATE APPEARANCE, FOR REFERENCE

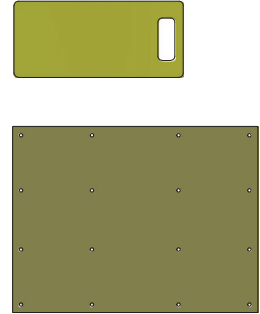

CONVERTED STEEL BALLAST ASSEMBLY, FWD - ITEMS TO INSTALL

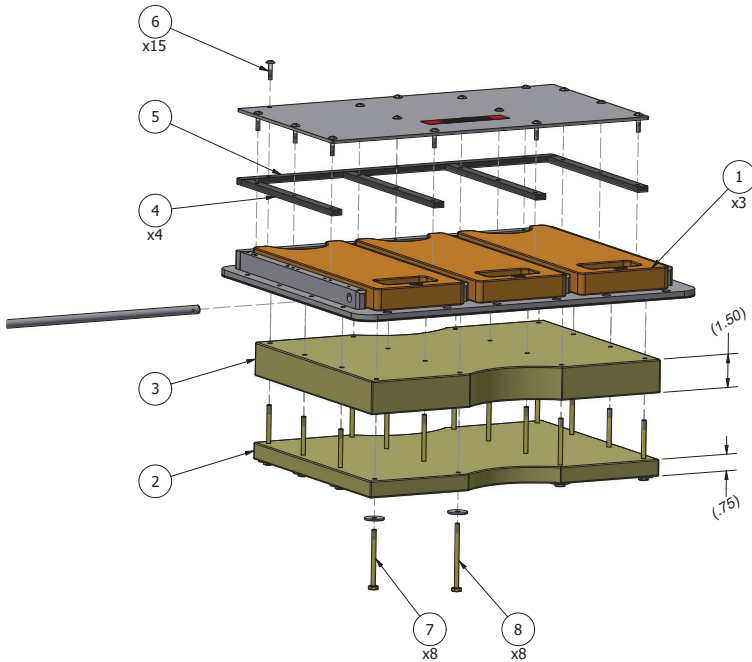

STEEL PLATE APPEARANCE, FOR REFERENCE

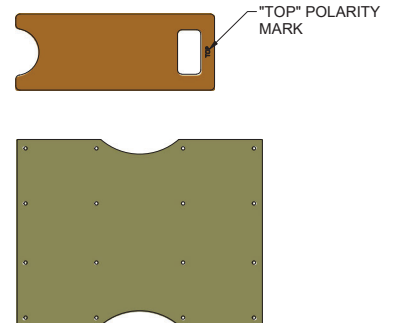

Figure 1 – Converting Fwd Ballast Assembly

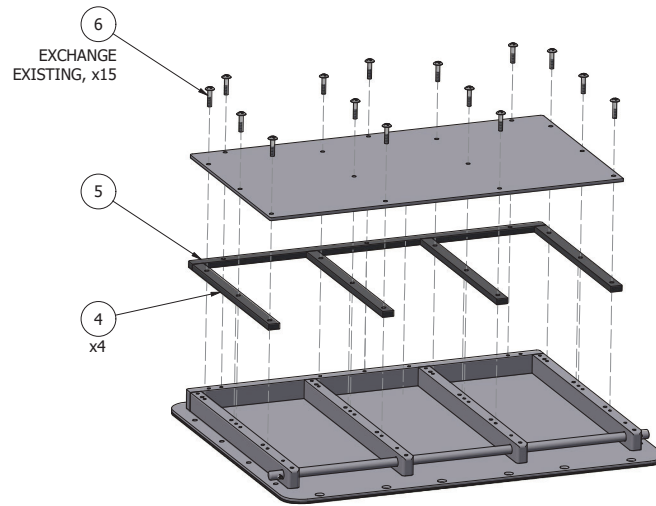

Figure 2 – Converting Aft Ballast Assembly

Aircraft Closing & Return to Service

Upon completion of inspection, enter information in Aircraft Logbook for completion of Wipaire Service Letter 267.