



WIPLINE FLOATS • SKIS • MODIFICATIONS • AIRCRAFT SALES
AVIONICS • INTERIOR • MAINTENANCE • PAINT REFINISHING

SERVICE LETTER 268

Fire Boss Scoop Tunnel & Side Cover Seal Addition

Aircraft Makes/Model(s):	Float Model(s):	Compliance: Optional	By: MAS
Air Tractor AT-802A & AT-802	10000A	Part Number: 1012757	Approved: DRH
		Date: 5/14/2025	Revision: B

LOG OF REVISIONS

Revision	Description	Date
A	Initial release	2/17/2025
B	Changed Access Cover Seal to Side Cover Seal. Updated title, headers, kits, step 5 in Scoop Tunnel section, and images. Reordered steps and images in Scoop Tunnel section.	5/14/2025

FAA approval has been obtained for technical data in this publication that affects STC or TSO design compliance.

EFFECTIVITY:

This service letter applies to Air Tractor AT-802 and AT-802A model aircraft with Wipline 10000 amphibian floats installed per STC SA01795CH.

COMPLIANCE:

Compliance is optional.

BACKGROUND:

Current methods of sealing the scoop tunnel have proven time consuming for technicians to work around, adding unnecessary additional labor costs to the maintenance process.

COMPLIANCE METHOD:

Per the work instructions, install scoop tunnel seals and side cover seal to reduce the effort required to access the scoop system.

APPROXIMATE SHOP HOURS:

Performing the work instructions will take approximately 3 labor hours to complete per aircraft. (1.5 hours per float).

WARRANTY INFORMATION:

This service letter does not include warranty for labor or parts.

TECHNICAL DATA:

Copies of this service letter, associated service kit (if applicable), float service manual, and float parts manual are available at www.wipaire.com.

1700 Henry Ave - Fleming Field (KSGS), South St. Paul, MN 55075

Phone: 651.451.1205 | Fax: 651.457.7858

www.wipaire.com



Reference the following documents for instructions pertaining to inspection and repair when completing the following tasks:

- AC43.13-1B or later FAA approved revision guidelines.

ITEMS PROVIDED IN SERVICE KIT 1012757-01 (FOR SINGLE FLOAT ONLY)			
ITEM	QTY	PART NUMBER	DESCRIPTION
1	2	1012637	GASKET, SCOOP TUNNEL
2	2	1012638	GASKET, COVER, SIDE
3	2	1012639	GASKET, CONNECTOR - PROBE TUNNEL COVER
4	1	1012848	GASKET, SCOOP TUNNEL, FWD
5	8	AN3-6A	BOLT, 10-32, 0.375 GRIP, UNDRILLED, STEEL

ITEMS PROVIDED IN SERVICE KIT 1012757-02 (FOR DUAL FLOAT SET ONLY)			
ITEM	QTY	PART NUMBER	DESCRIPTION
1	4	1012637	GASKET, SCOOP TUNNEL
2	4	1012638	GASKET, COVER, SIDE
3	4	1012639	GASKET, CONNECTOR - PROBE TUNNEL COVER
4	2	1012848	GASKET, SCOOP TUNNEL, FWD
5	16	AN3-6A	BOLT, 10-32, 0.375 GRIP, UNDRILLED, STEEL

Work Instructions

Side Cover

1. Remove hardware and side cover.
2. Clean Sealant from side cover.
3. Apply gasket 1012638 to inner facing side of cover.

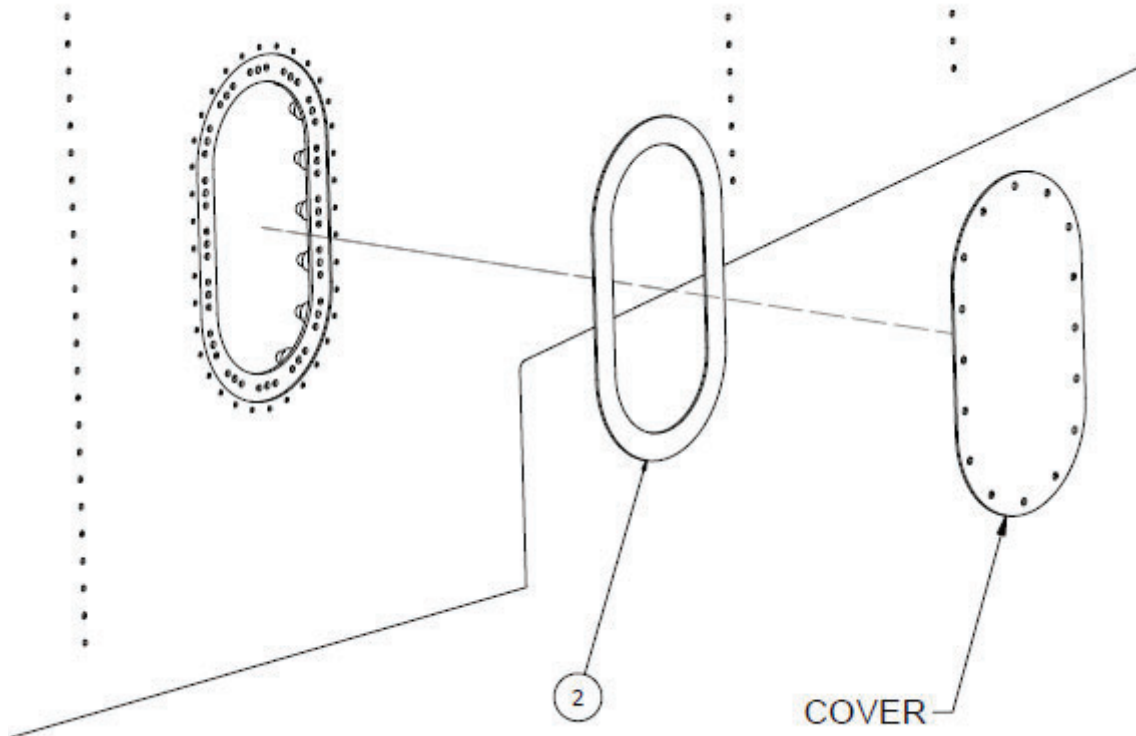

4. Using scribe or similar, puncture each bolt hole to allow fastener installation.
5. Reinstall side cover using existing fasteners.

Scoop Tunnel

1. Access scoop tunnel through aft panel in foam/baggage compartment.
2. Remove hardware and covers on top of scoop tunnel.
3. Clean sealant from covers and top and bottom of flanges.
4. Apply gaskets 1012637 and 1012848 to top of scoop tunnel.

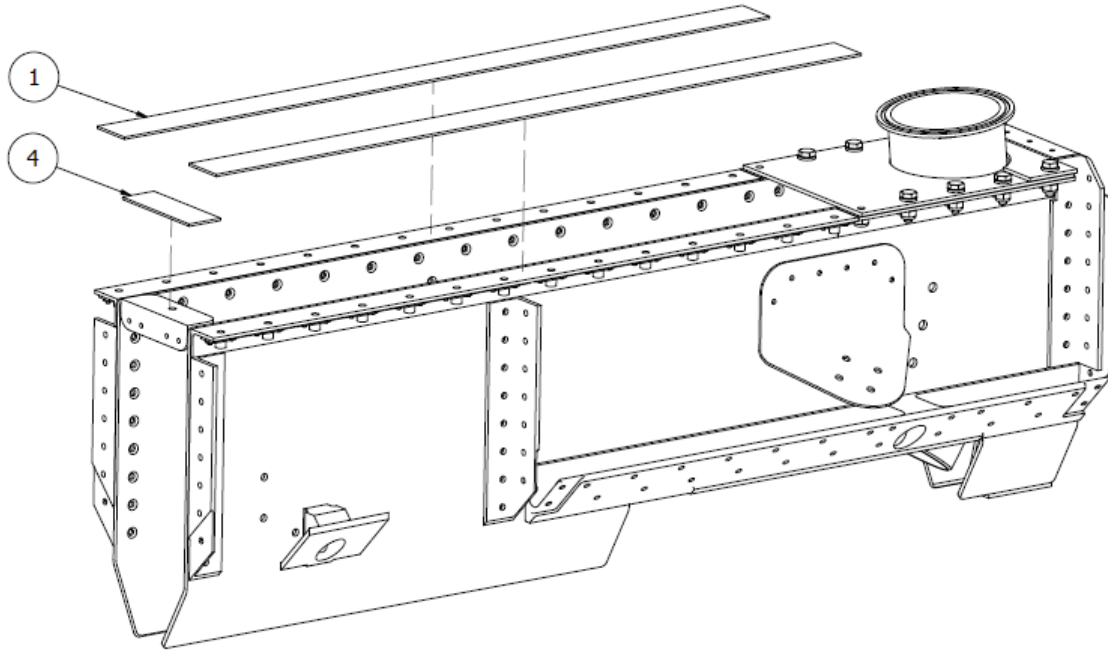

5. Using scribe or similar, puncture each bolt hole to allow fastener installation.
6. Apply gasket 1012639 to inner facing probe tunnel cover connector.

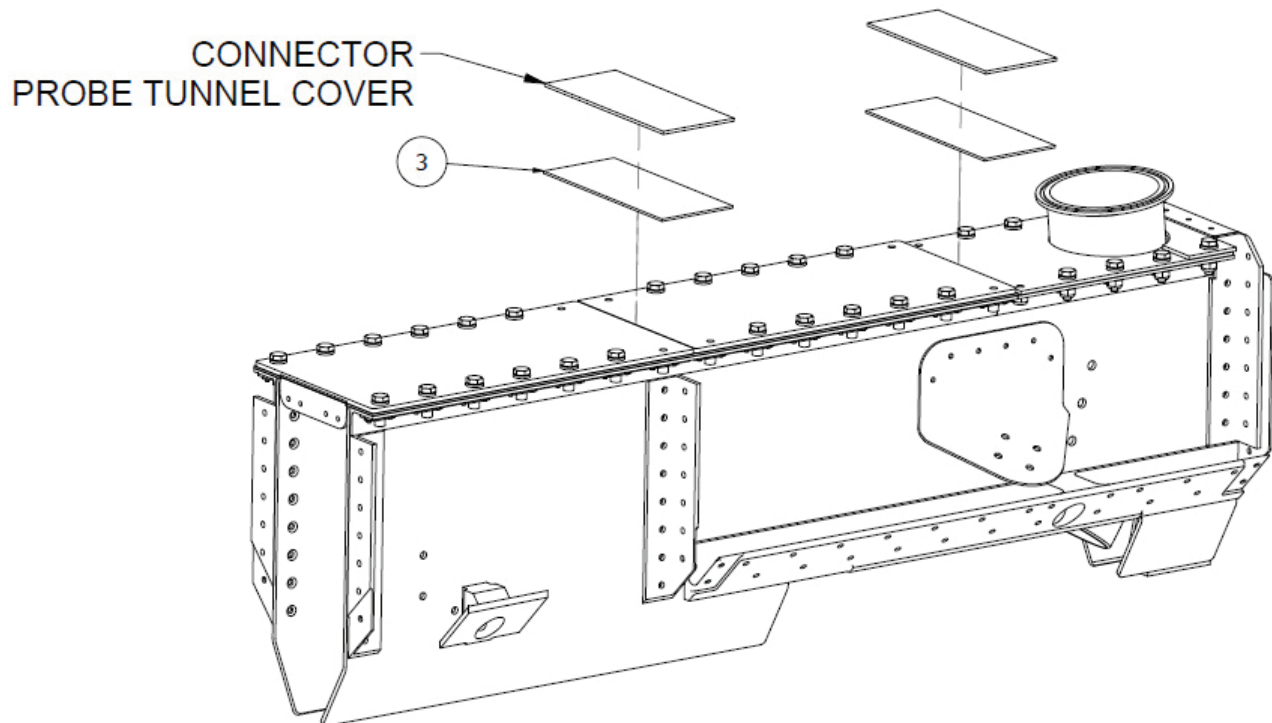

7. Reinstall tunnel covers, replacing the AN3-5A fasteners used on the probe tunnel cover connector with AN3-6A fasteners included in kit.

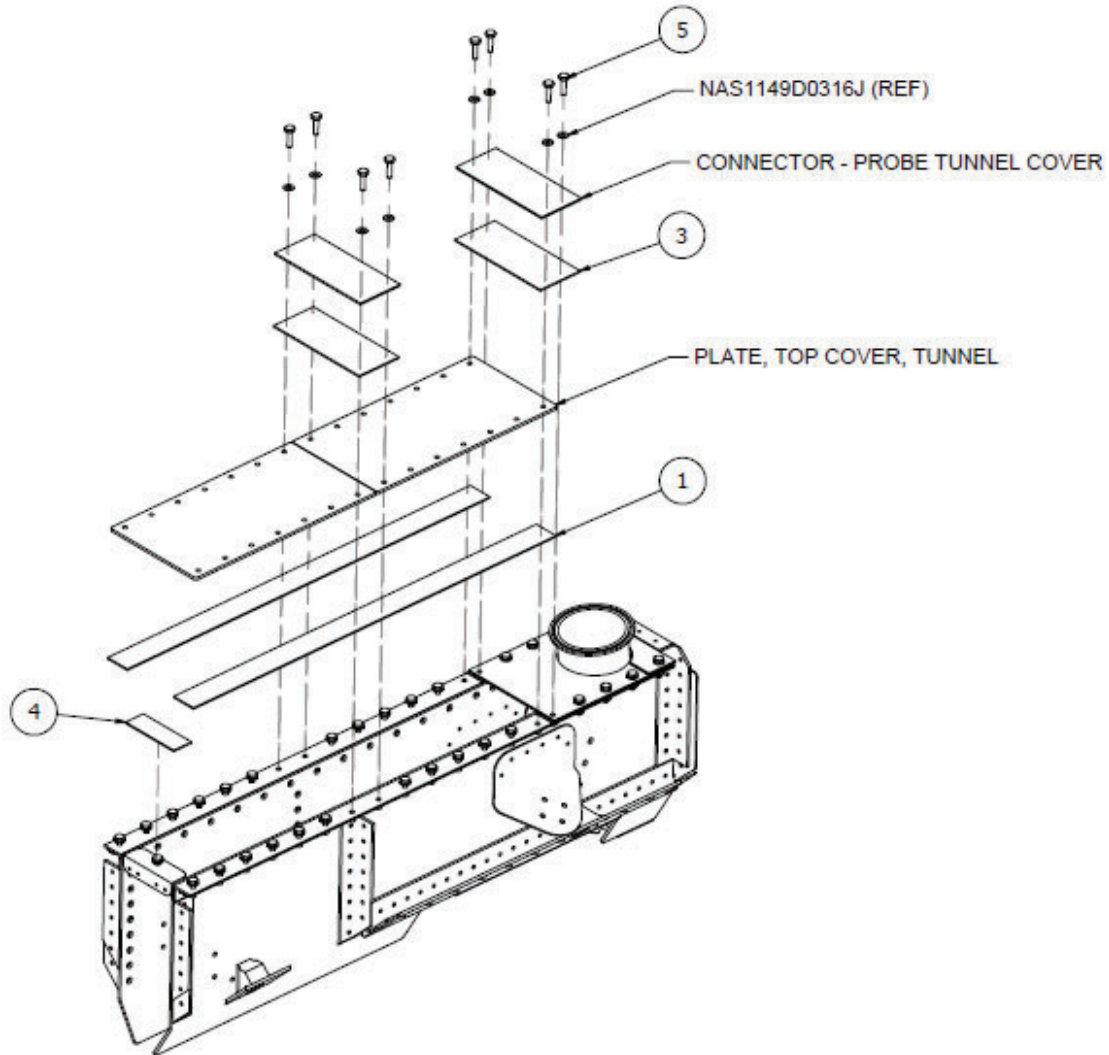

8. Leak check scoop tunnels.
 - a. Acceptable to use Momenitive Gray RTV 157 or equivalent to seal any gaps.

Aircraft Closing & Return to Service

Upon completion of inspection, enter information in Aircraft Logbook for completion of Wipaire Service Letter 268.